

608 BRUCE HIGHWAY, WOREE, QLD, 4868



# FOR LEASE

## START YOUR BUSINESS DREAM! PRIME OFFICES IN WOREE!

Set in a prime location in the highway in Woree, just South of Cairns, this stunning office space is an opportunity not to be missed. With an expansive 151 square meters of usable space, this property is the perfect place for any business looking for a prestigious address and modern office space.

The property has plenty of on-site parking, a rare commodity in this location.

The building is the perfect combination of convenience and luxury, with a modern design and plenty of space for any kind of business. The lobby is bright and inviting and the interior of the office is designed to be both functional and aesthetically pleasing.

The office is equipped with an array of modern features, including air conditioning, lighting, and data cabling. The office also has a well-equipped kitchen area with a microwave, refrigerator, and sink, so employees can make themselves a hot drink or lunch.

With its high profile location, modern design, and on site parking, this office space is a great opportunity for any business looking for a convenient offices in the heart of Woree.

Don't miss out on this fantastic opportunity, call us today to arrange an inspection.  
Note: Photos & video show the previous office fit out

0 BED | 0 BATH | 0 CAR

PRICE:  
\$0

OPEN FOR INSPECTION:  
N/A



**Bruce Holmes**  
**0402348695**  
holmescommercial@atrealty.com.au  
[www.atrealty.com.au](http://www.atrealty.com.au)

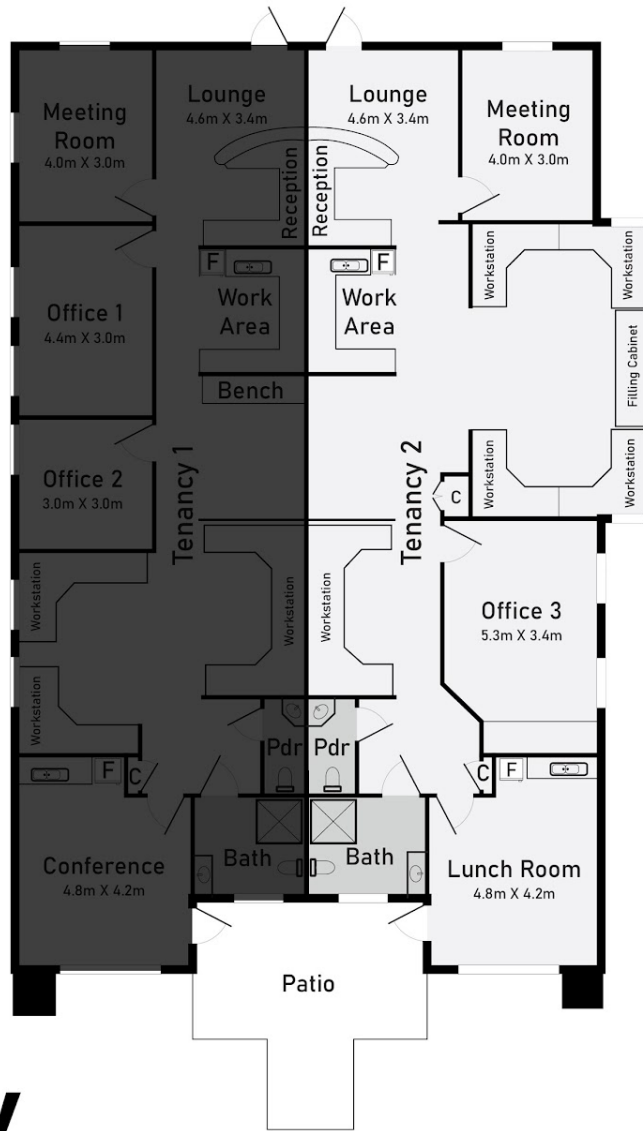

608 BRUCE HIGHWAY  
WOREE

Plan is for illustration purposes only  
Plan is not for sale

Disclaimer: Please note this floor plan is for marketing purposes and is to be used as a guide only. All dimensions are estimates only and may not be exact measurements.

