



SOLD

SOPHISTICATED AND SUN FILLED

Seamlessly engaging with indoor-outdoor splendor, this stylish townhouse is the ideal choice for young families, executives and investors with northerly sunshine streaming inside and quality appointments highlighting every space.

From the instant you step inside, the home's fluid ambience takes you from the living zones through to an adjoining dining area before linking with the kitchen that's finished with stone benches, stainless steel appliances, dishwasher and soft close cabinetry.

Ensuring the freedom to entertain inside and out is effortless, stacker sliding doors extend the open plan domain on to a covered alfresco entertaining zone and north-facing courtyard.

Set away from the living zone for complete peace and privacy, the three robed bedrooms rest on the upper level and include a master bedroom with walk-in-robe and ensuite, accompanied by a family bathroom with toilet.

Further complementing and comforting the home are a ground floor powder room, laundry, split system heating/air conditioning in the living and bedrooms, high ceilings, water tank, garden shed plus a single garage with internal access.

Quietly tucked back from the street, near Wattleview Primary, Boronia K-12 College, Tim Neville Arboretum, Dobson Park, Boronia Junction, Boronia Train Station, buses, Mountain Gate shops, Westfield Knox and EastLink Freeway.

Photo ID required at all open for inspections.

3 BED | 2 BATH | 1 CAR

PRICE:
\$640,000

OPEN FOR INSPECTION:
N/A



Marko Ghattas
0403170130
marko@atrealty.com.au
www.lucianorealty.com.au

3/117 Dorset Road BORONIA

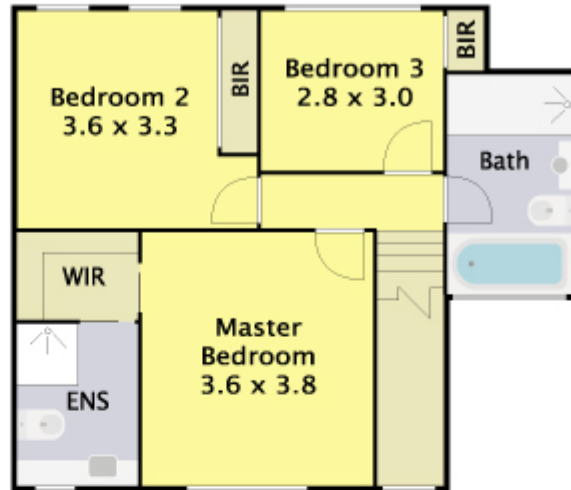

First Floor

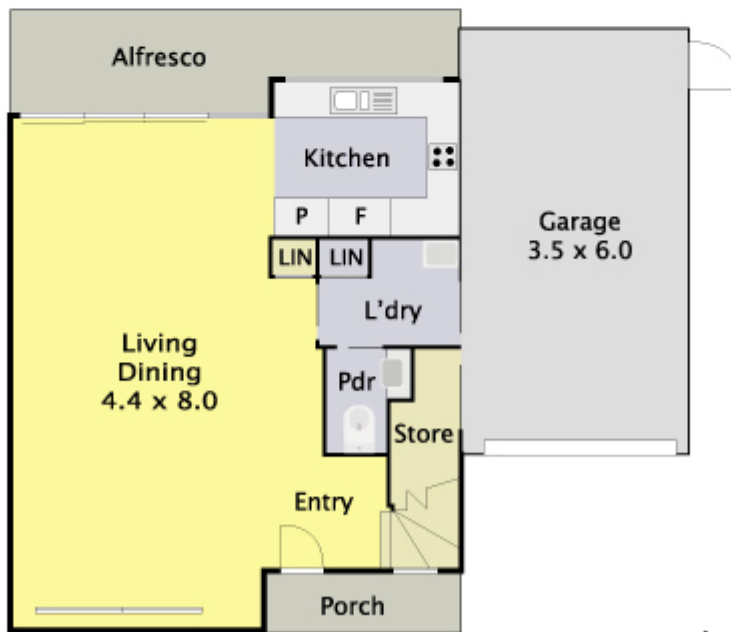
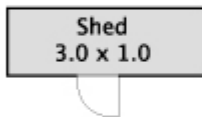

While every precaution has been taken to verify this information, it does not constitute any representation by the agent or vendor.

Disclaimer: Please note this floor plan is for marketing purposes and is to be used as a guide only. All dimensions are estimates only and may not be exact measurements.