



SOLD

MOVE IN READY

For more detailed info visit the dedicated property website at 22charltonrise.com

Welcome to your coastal sanctuary - A stunning house in the heart of Dalyston, VIC, Australia.

This beautiful three-bedroom, two-bathroom home is situated in a peaceful, family-friendly neighbourhood. Perfectly positioned with easy access to the local shops and amenities, this stunning residence offers all the comforts of modern living.

As soon as you walk through the front door you are welcomed by the abundance of natural light that pours in from the open-plan living and dining area. The living area features stunning limed oak floorboards and custom built-in cabinetry, finished off with a reverse cycle aircon, perfect for keeping cool in the warmer months. Adjacent to the living area is the contemporary bespoke kitchen, complete with built-in appliances, including a 90cm cooktop with double ovens and a dishwasher.

The master bedroom is generous in size offering a perfect space for relaxation and taking in the tranquil views along with a practical ensuite bathroom. The two additional bedrooms also feature built-in wardrobes. The family bathroom is both elegant and functional with a large soaking tub and shower.

Entertaining is a breeze in this home, with a spacious outdoor entertaining area and courtyard with ample space for friends and family to gather and unwind - while taking in the stunning rural views and rolling hills. A landscaped and fully fenced backyard and entertainment area complete the package.

This is a rare opportunity to secure a gorgeous family home with all the features you desire. With an impressive 104m² of internal living space, a land size of 517m² and two carparks, this home is ready for you to move into.

Be quick to inspect this stunning property and be the envy of all your friends and family. With all the features this home has to offer, this one won't last long. Contact your local real estate agent today to book an inspection.

3 BED | 2 BATH | 2 CAR

PRICE:
\$560,000

OPEN FOR INSPECTION:
N/A



Leo Edwards
0472523445
leo@atrealty.com.au
www.atrealty.com.au

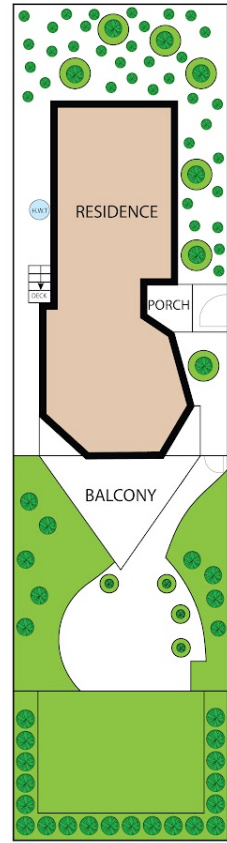
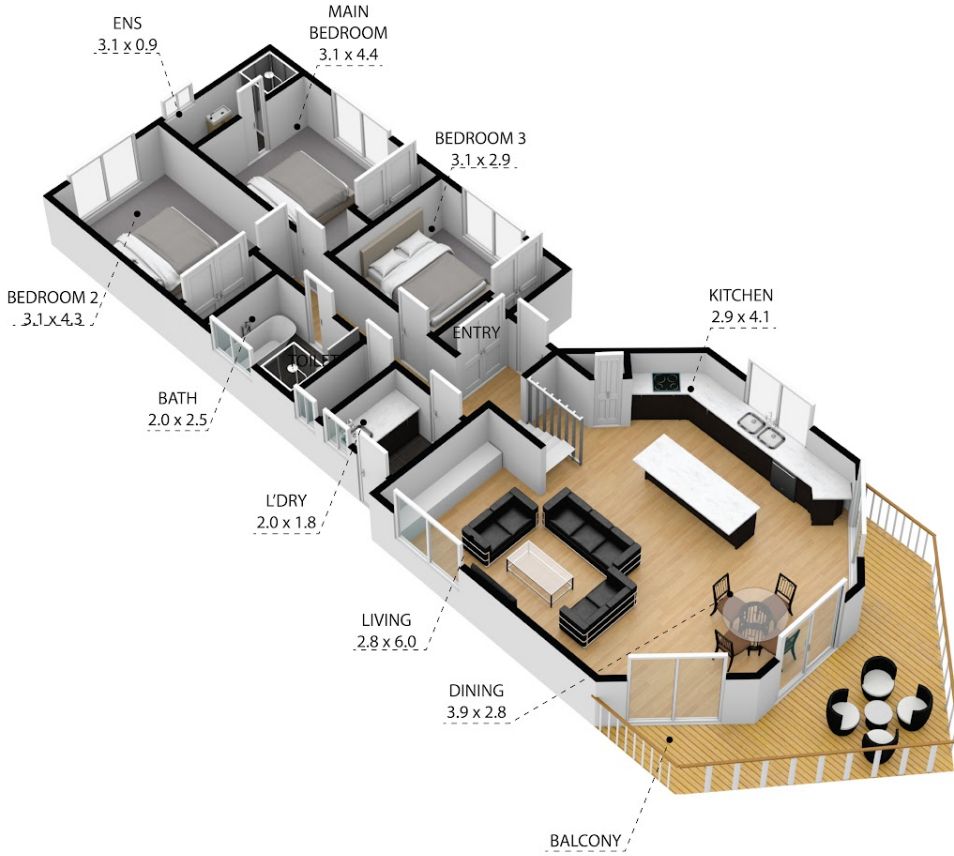

Charlton Rise, Dalyston 3992
 TOTAL APPROX. FLOOR AREA 104 SQ.M

Whilst every attempt has been made to ensure the accuracy of the floor plan contained here, measurements of doors, windows, rooms and any other items are approximate and no responsibility is taken for any error, omission, or misstatement. This plan is for illustrative purposes only and should be used as such by any prospective purchaser.



Disclaimer: Please note this floor plan is for marketing purposes and is to be used as a guide only. All dimensions are estimates only and may not be exact measurements.

Leo Edwards
 0472523445
 leo@atrealty.com.au
 www.atrealty.com.au

