

SOLD

SPACIOUS FAMILY HOME SET ON A 700M2 BLOCK

Do you need room for the grandparents or extra kids?

Take advantage and secure a home with 6 bedrooms and room for everyone in one of the most fastest growing regions in QLD.

Make it your own & breathe new life into this much-loved spacious family home set on a generous 700m2 block with an inground pool.

The thoughtfully designed main house layout boasts 4 bedrooms, 2 bathrooms, laundry, modern kitchen, dining room & formal lounge.

This home features a separate teenagers retreat with 2 bedrooms, air conditioning lounge and private access. It's a fantastic opportunity to earn extra income or somewhere for the kids or extended family.

Located in a quiet street within a great family friendly area!
Take a short drive to local schools, family parks, daycare centres, Bruce Highway & Morayfield Train Station.

Potential rental income: \$650 - \$700 per week

MAIN HOUSE:

- 700m2 block
- Large master bedroom with ensuite
- 3 additional bedrooms with BIR & ceiling fans
- Modern kitchen ft gas cooktop
- Open plan dining
- Formal lounge room
- Generous outdoor patio area
- Security screens throughout
- Separate laundry

6 BED | 2 BATH | 0 CAR

PRICE:
\$608,000

OPEN FOR INSPECTION:
N/A



Mitchell Younger
0488458887
mitchell.younger@atrealty.com.au
www.atrealty.com.au

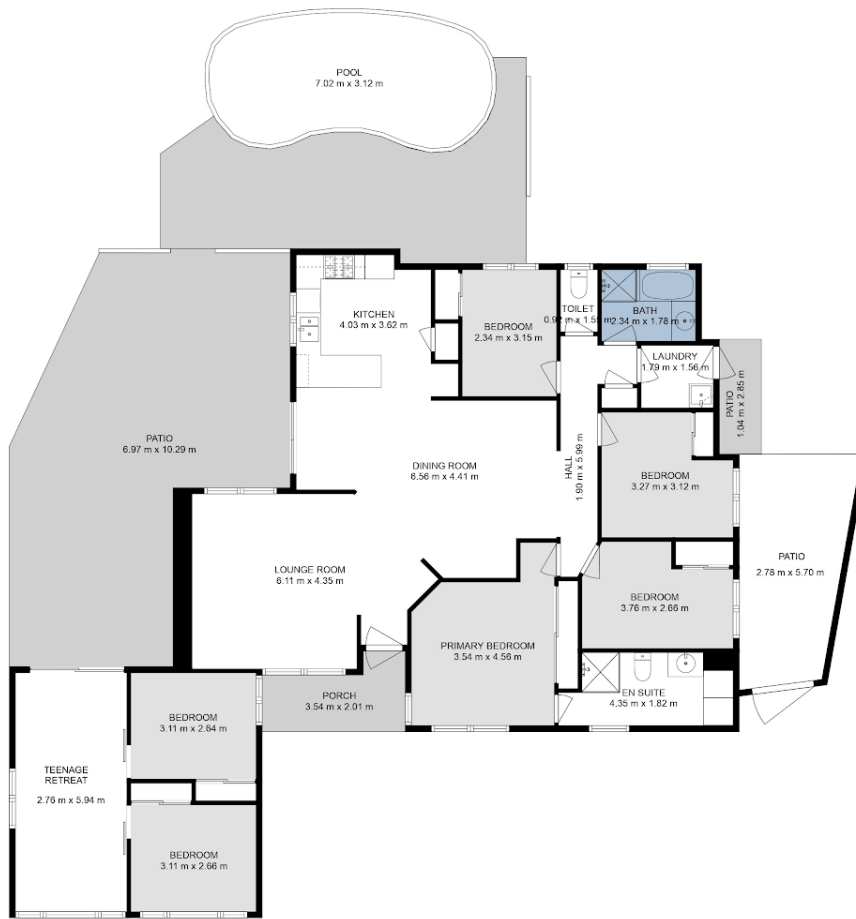

This floor plan is intended to give a general indication of the layout only. Sizes & dimensions are approximate, actual may vary.



Disclaimer: Please note this floor plan is for marketing purposes and is to be used as a guide only. All dimensions are estimates only and may not be exact measurements.