



**SOLD**

## BE IMPRESSED, QUALITY FAMILY HOME

Only an inspection will reveal the quality, size, and class of this stunning family home. Ideal for the large family, this home has large living areas, including 3 bathrooms, formal lounge, open kitchen meals family area extra living which could be a 5th bedroom, home office or games room.

A stunning sold timber kitchen is a feature of the home, with heaps of cupboard space, breakfast bench, quality appliances and stone splash backs.

Four large bedrooms with built in robes, plus the master is huge with walk in robe and en-suite. High ceilings, ornate cornice work, beautiful floor coverings plus quality fittings complement the home. The bathrooms have been tastefully upgraded and the colours throughout the home are neutral tones.

Ducted gas heating keeps the home warm all year round, plus 4 split system air-conditioners positioned throughout the home, keeps you cool through those summer months.

Enclosed patio area is great for Family gatherings with double zip track blinds for summer and winter needs.

Double garage under the main roof with great rear yard access to a large private yard with double garage and raised garden beds.

Fully enclosed backyard is ideal for children and pets.

20 panel solar system and battery keeps your power bills and a minimum.

The Current owners would like to lease back for minimum of 6 to 12 months at \$600.00 per week to the ideal buyer till their new residence is available.

RLA 269823

**4 BED | 3 BATH | 4 CAR**

**PRICE:**  
\$590,000

**OPEN FOR INSPECTION:**  
N/A



**Peter Dempsey**  
**0418854393**  
peterdempsey@atrealty.com.au  
[peterdempseyatrealty.com](http://peterdempseyatrealty.com)  
RLA: 269823

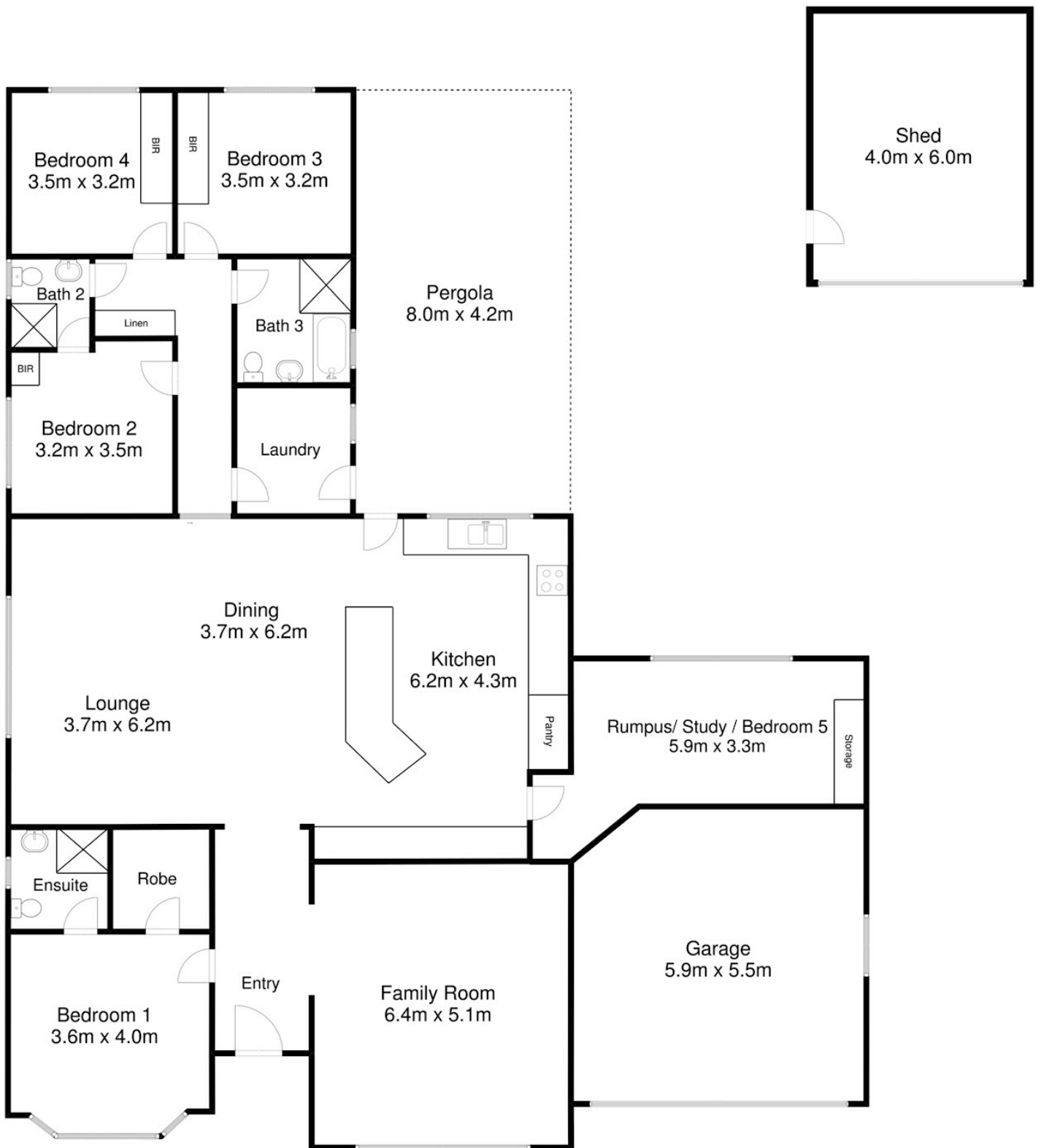

Disclaimer: Floor Plan measurements are approximate and are for illustrative purposes only. While we do not doubt the floor plans accuracy, we make no guarantee, warranty or representation as to the accuracy and completeness of the floor plan

Disclaimer: Please note this floor plan is for marketing purposes and is to be used as a guide only. All dimensions are estimates only and may not be exact measurements.