



**SOLD**

## PRIME LOCATION

Cleverly designed for comfort and perfectly located in the heart of Pakenham. Whether you are looking for your first home to down-size or invest this near New 2-bedroom Unit will tick all the boxes. Offering spacious layout with bright and generous living space. This clean and fresh home features open space living and dining accompanied by an open-plan kitchen fitted with stone benchtop and glass splash back, stainless-steel appliances and dishwasher, neat bathroom, separate laundry and two bedrooms with built in robes. Packed with comforts such as gas ducted heating, split system air conditioner, ample storage and a remote lock-up carport.

**PRIME LOCATION** - Well connected to major roads and public transport and it's just around the corner from the Pakenham Town center and all it has to offer - Walking distance to:  
Pakenham Central Market place, Big W, Woolworths & more. (500m)  
Main Street Pakenham, post office, cafes, medical clinics, childcare. (650m)  
Pakenham Train Station (1000m)  
Library (400m)

### PROPERTY FEATURES

- Ducted Heating
- Air-conditioned living area
- Master Bedrooms with walk in robe and semi-ensuite
- Kitchen with stone bench top and glass splash back
- Built In Wardrobes
- Courtyard
- Remote Carport
- Laminate flooring

Ideal for first home buyers, investors, downsizers and young families.  
Call Marko Rankovic  
0427 771 810

**2 BED | 1 BATH | 1 CAR**

**PRICE:**  
\$440,000

**OPEN FOR INSPECTION:**  
N/A



**Marko Rankovic**  
**0427771810**  
markorankovic@atrealty.com.au  
[www.atrealty.com.au](http://www.atrealty.com.au)



**FLOOR PLAN**

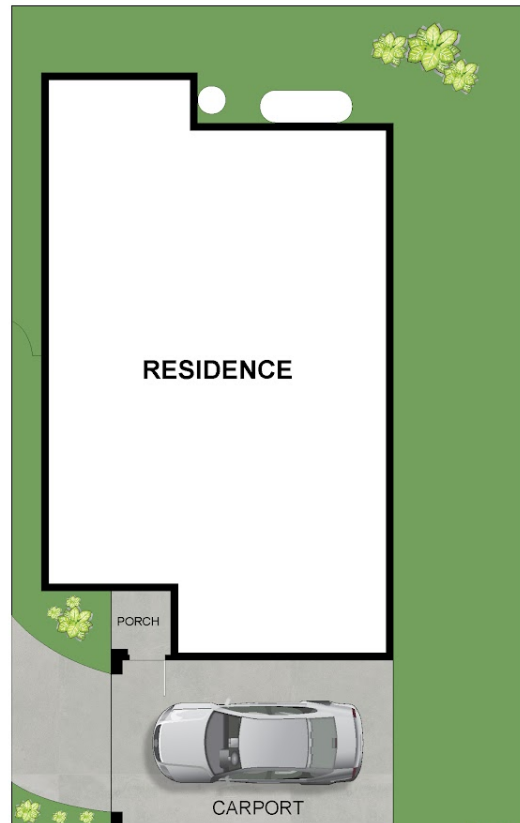

**SITE PLAN**



**Property Address: UNIT 4,13 ANDERSON STREET, PAKENHAM**

Disclaimer: Please note this floor plan is for marketing purposes and is to be used as a guide only. All dimensions are estimates only and may not be exact measurements.