

**SOLD**

## LOOKING FOR AN OVERSIZED AND STYLISH 1-BEDROOM APARTMENT IN BRUNSWICK? LOOK NO FURTHER!

Welcome to this exciting living space in the heart of Brunswick, a thriving and vibrant inner suburb of Melbourne. Blessed with natural light and offering a very generous 60.00 square meters of floor area, this stylish one-bedroom apartment is the ideal place to call home.

The interior is designed for entertaining, featuring a large sunken living area with polished floorboards that opens onto a private balcony. The kitchen overlooks the living space and offers quality appliances and a dishwasher for those who love to cook.

This apartment is for those looking for an inner-city lifestyle or investment opportunity, with security entry from Sydney Road and a secure undercover car park for those who need to commute or want the convenience of a car nearby. It also includes a built-in wardrobe in the bedroom, heating and cooling and laundry.

This oversized one-bedroom apartment is an excellent opportunity for those looking for a low-maintenance lifestyle without compromising style and convenience. Located in the heart of Brunswick, it is close to all the amenities the inner city offers, including the train, tram, cafes, restaurants, bars, shopping centres and more.

So don't miss out on this fantastic opportunity. Contact us now to arrange an inspection and make this apartment your new home.

1 BED | 1 BATH | 1 CAR

PRICE:  
\$487,500

OPEN FOR INSPECTION:  
N/A



**Leigh Chant**  
**0418100082**  
leighchant@atrealty.com.au  
[innermelbournere.com.au](http://innermelbournere.com.au)

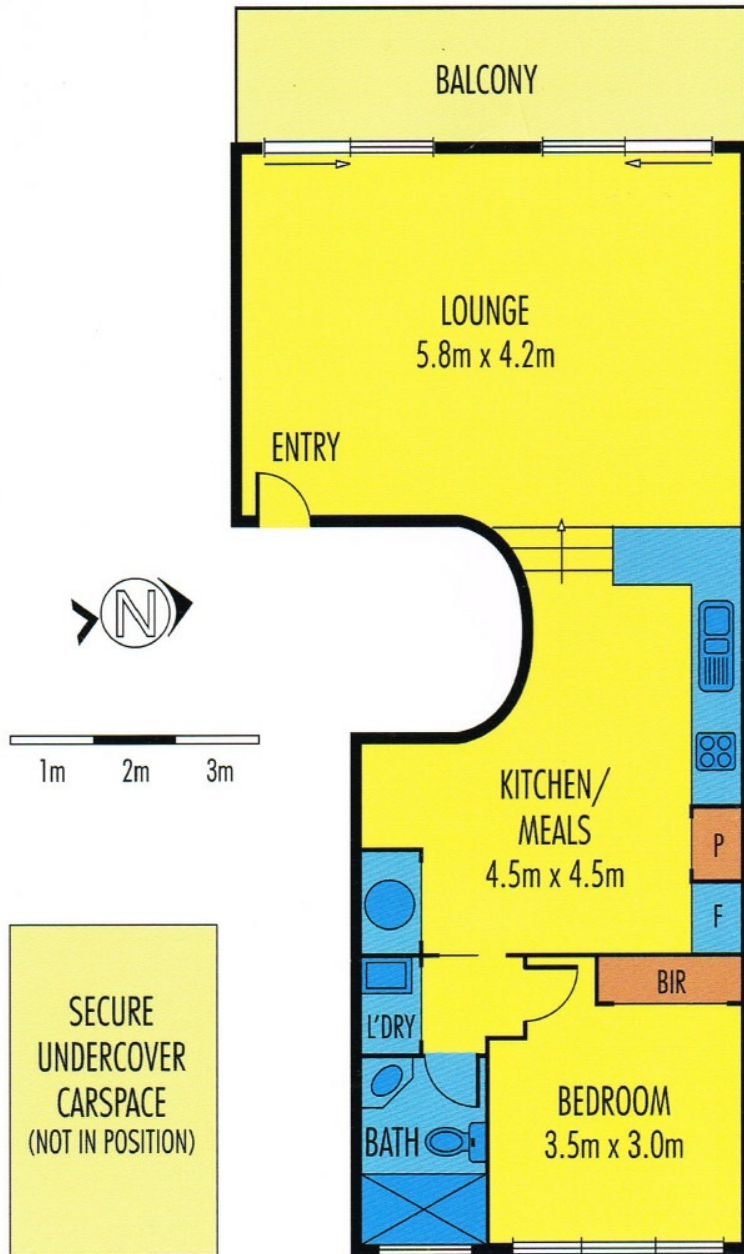

Disclaimer: Please note this floor plan is for marketing purposes and is to be used as a guide only. All dimensions are estimates only and may not be exact measurements.