



SOLD

SEIZE YOUR SEA CHANGE - 4 BED HOUSE ON 629 SQM IN INVERLOCH, VIC

Discover an incredible opportunity to secure a family home in the beautiful coastal town of Inverloch, VIC. This four-bedroom, two-bathroom home with a garage and large driveway, has plenty of space for a boat, caravan or both and is available now to make your own.

Situated on a generous 630 square meter block, it will provide a secure, low-maintenance lifestyle or a solid rental return.

The home features a range of both indoor and outdoor features, perfect for entertaining family and friends. There is a fully fenced yard, including a shed and balcony, as well as secure parking and storage areas. Indoors, the house is complete with upstairs and downstairs living areas, along with four large bedrooms, and two bathrooms, one featuring a spa bath.

This property has been built with comfort and convenience in mind, with a wood heater for the cooler months. The home also includes a deck off the main living areas, perfect for balmy Inverloch summer days or hosting a barbecue with friends.

This much-loved home is perfect for a family looking to settle into a warm and welcoming neighbourhood with all amenities close by. Inverloch is well-known for its stunning coastline, beaches, and laidback vibe, as well as its vibrant community life.

Take advantage of this fantastic opportunity to secure a spacious home in a stunning coastal town, and start living the dream. Enquire now to arrange an inspection and find out more about this great property.

4 BED | 2 BATH | 1 CAR

PRICE:
\$690,000

OPEN FOR INSPECTION:
N/A



Leo Edwards
0472523445
leo@atrealty.com.au
www.atrealty.com.au

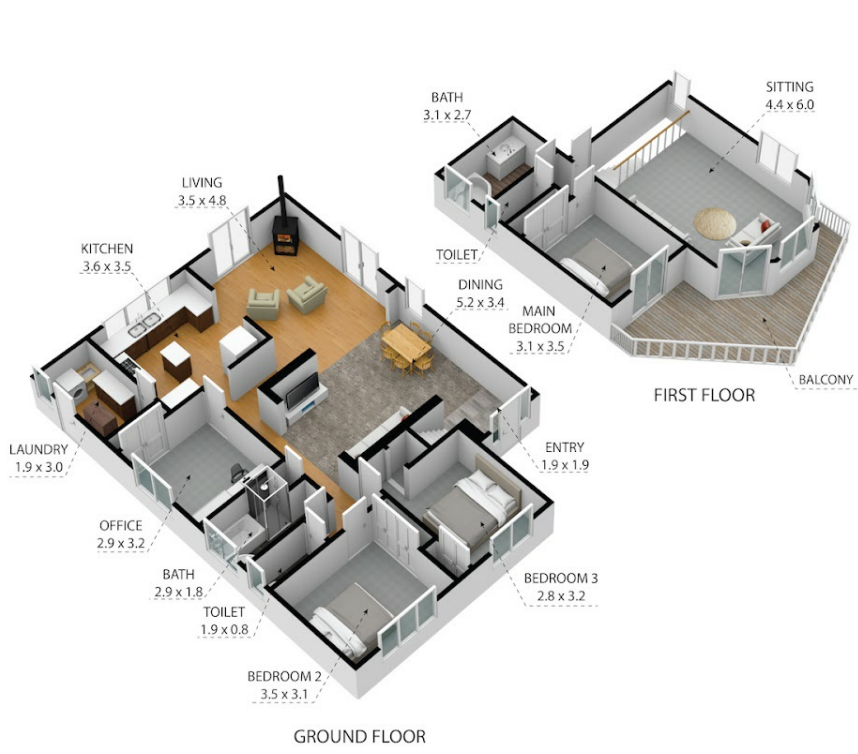

49 Wonthaggi Road, Inverloch 3996

TOTAL APPROX. FLOOR AREA 169 SQ.M

Whilst every attempt has been made to ensure the accuracy of the floor plan contained here, measurements of doors, windows, rooms and any other items are approximate and no responsibility is taken for any error, omission, or misstatement. This plan is for illustrative purposes only and should be used as such by any prospective purchaser.



Disclaimer: Please note this floor plan is for marketing purposes and is to be used as a guide only. All dimensions are estimates only and may not be exact measurements.

Leo Edwards
0472523445
leo@atrealty.com.au
www.atrealty.com.au

