



FOR SALE

"ESCAPE TO PARADISE - 3 BEDROOM HOME ON 998M2(APPROX).

Welcome to Pioneer Bay, Victoria, and this three-bedroom family home.

This charming property is situated on a 1/4 acre of land, allowing plenty of room for you to make it your own...

This bright and airy weather board home of beautiful proportions still retains many of the original features. The home is perfect for a family, with three spacious bedrooms and one bathroom. The bedrooms have plenty of natural light and are of good size. The home has potential to have a 4th bedroom, home office or playroom.

The heart of the home is the kitchen and meals area, where you can enjoy family meals and with easy access to the updated decking, perfect for entertaining family and friends. Stay cool in summer with the split system and cosy & warm with the wood fire during the winter months. The beautiful outdoor setting is completed with mature trees, a good sized undercover deck and plenty of room for the kids to play in the secure yard. Room for an outdoor pool, or even completing the veggie patch – the possibilities are truly endless. There is also a double car garage.

This property has so much to offer, and it is ready for you to move in and make it your own. With a great location and plenty of potential, this could be your perfect home. Make it yours today - it won't last long!

3 BED | 1 BATH | 1 CAR

PRICE:

\$550,000 - \$600,000

OPEN FOR INSPECTION:

N/A



Mel Ahearn

0409183763

mahearn@atrealty.com.au

atrealtypropertysalesgippsland.com.au



FLOOR PLAN

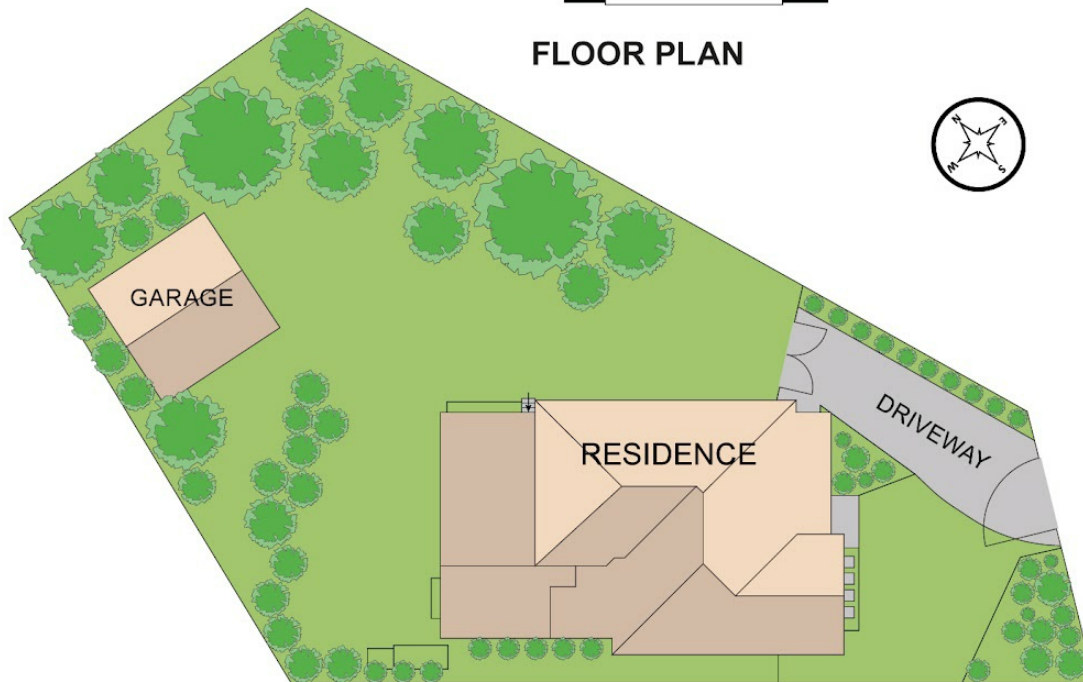

SITE PLAN

49 DAISY AVE, PIONEER BAY

Disclaimer: Floorplan is for illustration only, prospective purchasers are advised to make their own enquiries.

COMPLETE IMAGE
ARCHITECTURAL + REAL ESTATE MEDIA



Disclaimer: Please note this floor plan is for marketing purposes and is to be used as a guide only. All dimensions are estimates only and may not be exact measurements.