



## FOR LEASE

### PERFECTLY POSITIONED: BRIGHT AND SPACIOUS LARGE GROUND FLOOR ONE BEDROOM APARTMENT IN MOONEE PONDS!

Located in a solid brick boutique block, this one-bedroom ground-floor apartment features open-plan living that opens to an outdoor balcony, providing abundant natural light.

The modern kitchen has a stainless steel oven and induction cooktop, an extra-large bedroom with built-in robes, a spacious bathroom/laundry with excellent storage above and below the bench, a shower and a separate bath.

Puckle Street, Moonee Ponds, is a vibrant area with many restaurants, shops, cafes, Coles, Woolworths, Kmart and Aldi. The new Palace Cinema complex (including Rooftop Bar Cinema Brunetti's Cafe at Penny Lane is within walking distance. Excellent transport options include Moonee Ponds train station, trams and bus interchange.

The apartment is available from the 15th of April.

APPLICATIONS WILL ONLY BE ACCEPTED VIA THE FOLLOWING LINK:  
<https://myatrealty.com/v2/properties/71236/listing/51070/applicants/application-form>

1 BED | 1 BATH | 0 CAR

PRICE:  
\$430 per week

OPEN FOR INSPECTION:  
N/A



**Leigh Chant**  
**0418100082**  
[leighchant@atrealty.com.au](mailto:leighchant@atrealty.com.au)  
[innermelbournere.com.au](http://innermelbournere.com.au)

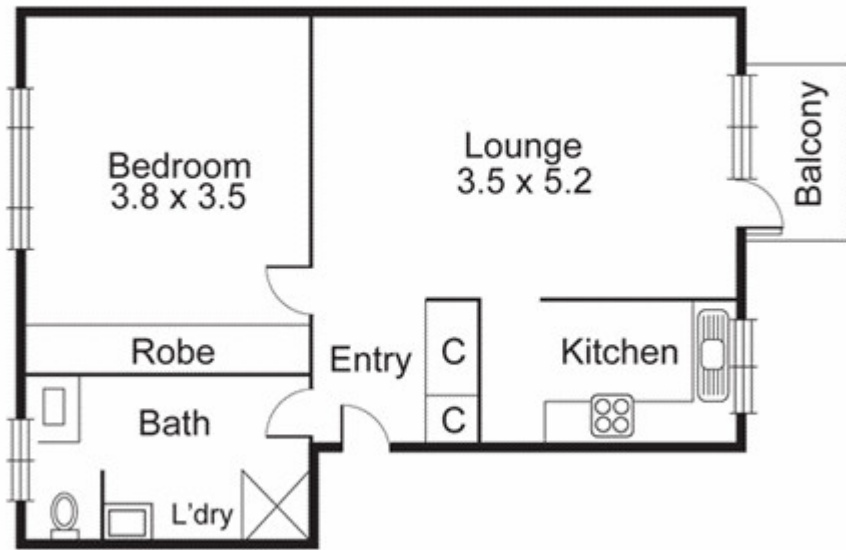

Disclaimer: Please note this floor plan is for marketing purposes and is to be used as a guide only. All dimensions are estimates only and may not be exact measurements.