



**SOLD**

## THE EXTRAS AND LOCATION WILL IMPRESS

Presenting to the market this impressive five bedroom single level owner occupier home in the prestigious Eatons Rise Estate just a hop skip and a jump to the fabulous flat walking paths, bbq's and great parks! Situated on a sizable 800m2 fully fenced block, this property offers privacy, air-conditioning, modern kitchen, entertaining, room for the fur babies and children to run.

Upon entering you will appreciate how well kept this home is, welcoming you in is quality modern flooring, to your left is bedroom 5/home office equipped with ceiling fan and air conditioning and to your right one of the separate living spaces is located then the home quite literally unfolds before your eyes with a massive living, dining and kitchen area.

You will love the position of the galley style gourmet kitchen, the cook of the family can produce meals in style utilising the induction stove, double oven, integrated dishwasher and stone benchtops. The breakfast bar island makes this very much the social hub, a place to meet and discuss the happenings of the day, while dinner is being prepared, homework is being done and a glass of wine is being enjoyed.

Sliding doors lead seamlessly to the outdoor alfresco area, making this space usable all year round. Sitting here in the tranquillity entertaining friends and family at the end of a long week is what life is all about!

Back inside you will discover the master suite with walk in robe and generously sized ensuite with a lovely large shower, air-conditioned comfort of course and ceiling fan. The other three bedrooms all feature built in robes and ceiling fans. The central bathroom services these rooms featuring a separate toilet to cater for those busy mornings.

To further compliment this magnificent home is Tinted Windows, TermiMesh Termite Barrier and Solar panels just to name a few. Properties of this calibre and location do not present often.

Don't delay, call Natalie today on 0419689309.

At a glance:  
Fully Fenced Elevated 800m2 block  
Solar – 4.6kw

**5 BED | 2 BATH | 2 CAR**

**PRICE:**  
**\$965,000**

**OPEN FOR INSPECTION:**  
N/A



**Natalie Johnston**  
**0419689309**  
natalie@atrealty.com.au  
[Natalieatrealty](#)

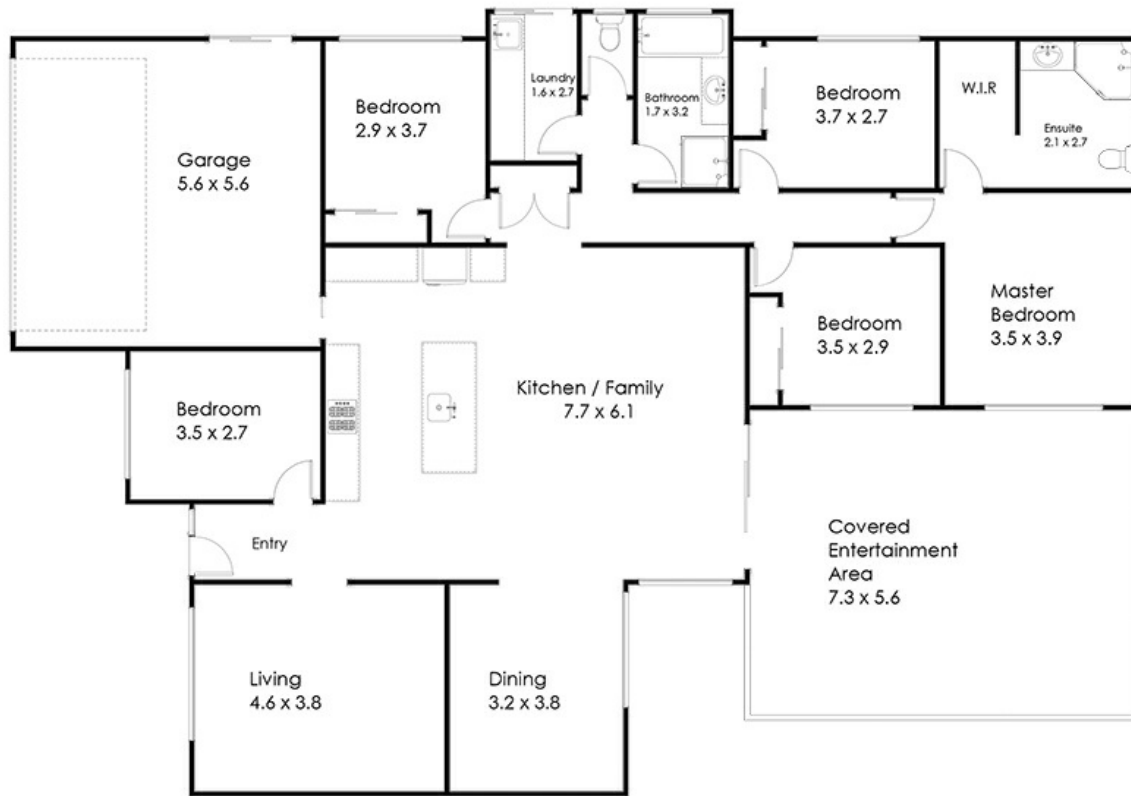

8 Diorama Circuit Eatons Hill 4037

Whilst every attempt has been made to ensure the accuracy of the floor plan contained here, measurements of doors, windows rooms and any other items and structures are approximate and no responsibility is taken for any error, omission or mis-statement. Bathroom and kitchen fittings, cupboards and door types and laundry appliances and windows are tokens and approximate the actual fitting installed.

This plan is for illustrative purposes and should be used as such by any prospective buyer. Plan drawn by Eagle Eye Photography Service, www.eagleeyehq.com.au Copyright 2023. All rights reserved. No reproduction without license, contact photographer for more information.

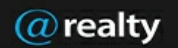

Disclaimer: Please note this floor plan is for marketing purposes and is to be used as a guide only. All dimensions are estimates only and may not be exact measurements.