



SOLD

NEST OR INVEST!

The perfect opportunity awaits you in Moe – a two-bedroom, one-bathroom unit just waiting for you to make it your own.

Situated in an over 55's retirement complex, this unit has the potential to become your ideal home or investment. Bright and airy, the interior is spacious, and each room is flooded with light. An open plan living and dining area, as well as two generous bedrooms and a bathroom are all included in this desirable property.

The kitchen is well-equipped, with plenty of storage and bench space. The bedrooms are generous in size with plenty of natural light. The bathroom/laundry is also well-appointed, with a shower, vanity, and enough room to get ready in the morning. Outside, you can enjoy the peace and tranquility in the sunny backyard.

Take advantage of this unique opportunity and make your dreams of home ownership a reality. With the property already tenanted, you benefit from instant income. The current rent is \$250 per week, giving you the latitude to increase rents and maximise your return on investment. Lease expires in September.

The location is also desirable, offering easy access to local schools and train station. Enjoy the convenience of nearby shops, and cafes, as well as picturesque parks and lush green spaces. With close proximity to public transport, you'll find commuting to work or Melbourne a breeze.

All in all, a sound investment awaits your opportunity. Call Jeff for an inspection today

The information about this property has been supplied to us in good faith, while we have no cause to doubt its accuracy. Land and home dimensions and floor/site plans are supplied by third parties. Typing mistakes and omissions transposing can occur, we provide assistance but make no representation. Buyers must carry out their own due diligence.

2 BED | 1 BATH | 0 CAR

PRICE:
\$225,000

OPEN FOR INSPECTION:
N/A



Jeff Dalzotto
0411601046

jeffd@atrealty.com.au

atrealtypropertysalesgippsland.com.au

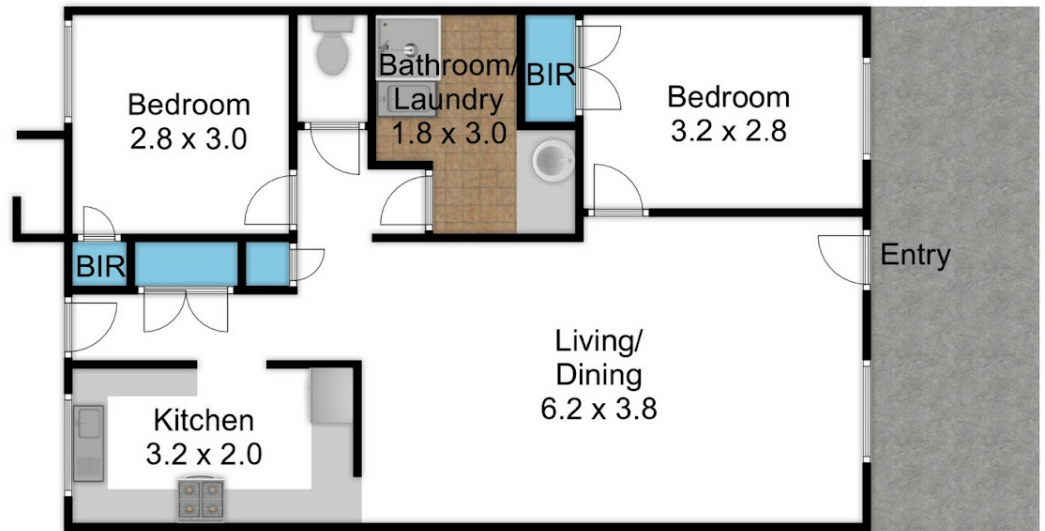

11/15 Burrage Street - Moe



Disclaimer: Please note this floor plan is for marketing purposes and is to be used as a guide only. All dimensions are estimates only and may not be exact measurements.