



**SOLD**

## INTRODUCING AN ELEGANT OFFICE SPACE WITH IMPRESSIVE VIEWS!

Are you in search of a prestigious office space that offers breathtaking panoramic views? Look no further! This 161m<sup>2</sup> office located on the 14th floor presents a remarkable workspace with a touch of luxury.

Step inside and experience the captivating vistas that surround you. With stunning views spanning Albert Park Lake and Golf Course, Port Phillip Bay, and the Shrine of Remembrance, this office guarantees a serene and inspiring environment to elevate your professional endeavors.

Designed for excellence, this office features four executive offices, providing ample space for private meetings and focused work. The impressive boardroom is ideal for hosting client presentations and important discussions. Additionally, two open-plan areas encourage collaboration among team members, fostering a dynamic and innovative work culture.

Located within the esteemed St Kilda Rd Towers, you will enjoy access to premium amenities designed to enhance your work-life balance. Benefit from the services of a dedicated Concierge, available Monday to Saturday, ensuring your needs are met with professionalism. Stay fit and energized at the on-site gymnasium or savor a delicious meal at the food court or the renowned Squires Loft Restaurant and Bar. Secretarial support is available to streamline your administrative tasks, allowing you to focus on what truly matters. Additional perks include storage units and secure undercover car parking for your convenience and peace of mind (available at an additional cost).

Positioned in the vibrant St Kilda Road business precinct, this office enjoys a prime location with easy access to the city centre. Surround yourself with renowned businesses, cultural attractions, and exquisite dining options. With excellent transport links and proximity to key landmarks, your clients and team members will appreciate the convenience and prestige of this coveted address.

Don't miss the chance to secure this exceptional office space for yourself! Contact us today to arrange a viewing.

INSPECTIONS BY APPOINTMENT ONLY. ENQUIRE NOW TO SCHEDULE YOURS!

0 BED | 0 BATH | 0 CAR

PRICE:  
\$660,000

OPEN FOR INSPECTION:  
N/A



**Scott Collins**  
0499005265  
scottcollins@atrealty.com.au  
[scottcollins.com](http://scottcollins.com)

# 1413 1415/1 Queens Road, Melbourne

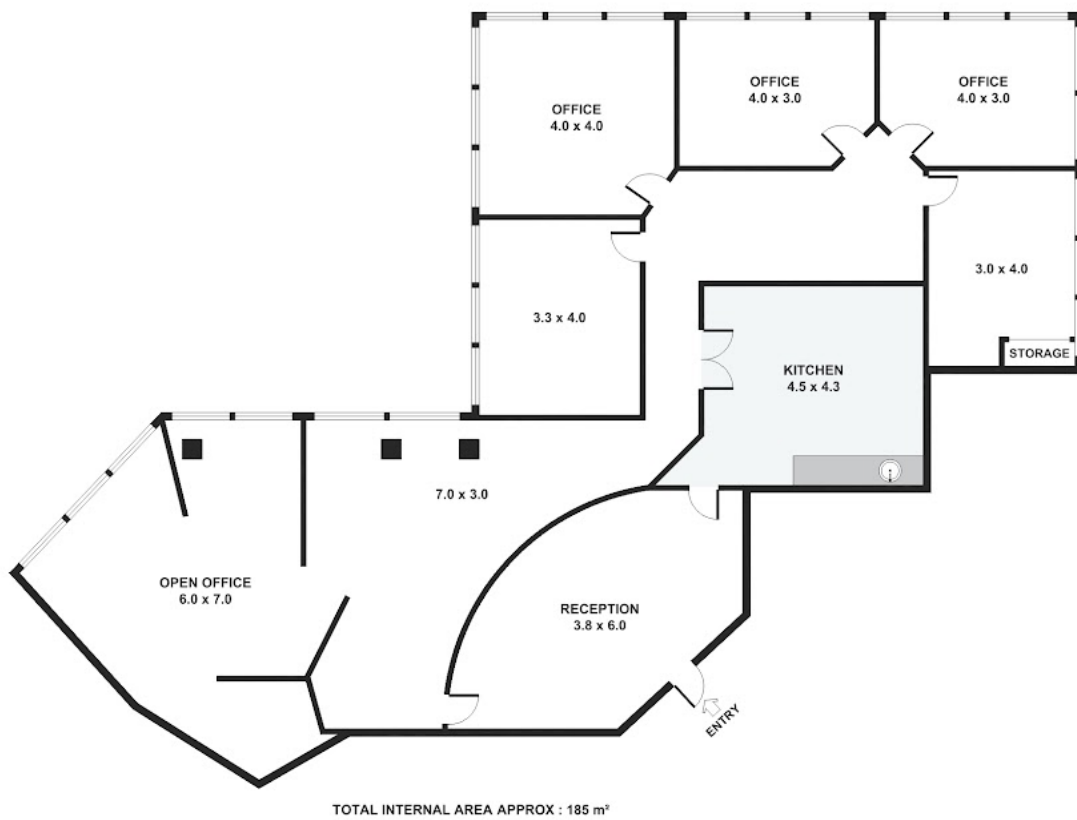

Disclaimer: Please note this floor plan is for marketing purposes and is to be used as a guide only. All dimensions are estimates only and may not be exact measurements.

Please note: All stated dimensions are approximate only. Particulars given are for general information only and do not constitute any representation on the part of the vendor or agent.