



SOLD

GREAT PROPERTY ! READY TO MOVE IN OR RENT OUT WITH POTENTIAL TO SUBDIVIDE INTO GOOD SIZED BLOCKS.

Built in 1963 on a 702 sqm block with Approximately 21.6m Frontage 38m Sides and 15m Rear. Containing 3 bedrooms all with built in wardrobes. Polished Timber flooring with new tiles in the kitchen Updated bathroom and kitchen.

Beautifully paved and landscaped rear yard with carport and shed.

Roller shutters throughout the house.

Great opportunity for home, investment or develop.

Call Minh Nguyen Today to make a booking for inspection.

3 BED | 1 BATH | 6 CAR

PRICE:
\$300,000

OPEN FOR INSPECTION:
N/A



Minh Nguyen
0479070072
minh@atrealty.com.au
www.atrealty.com.au
RLA: 269823

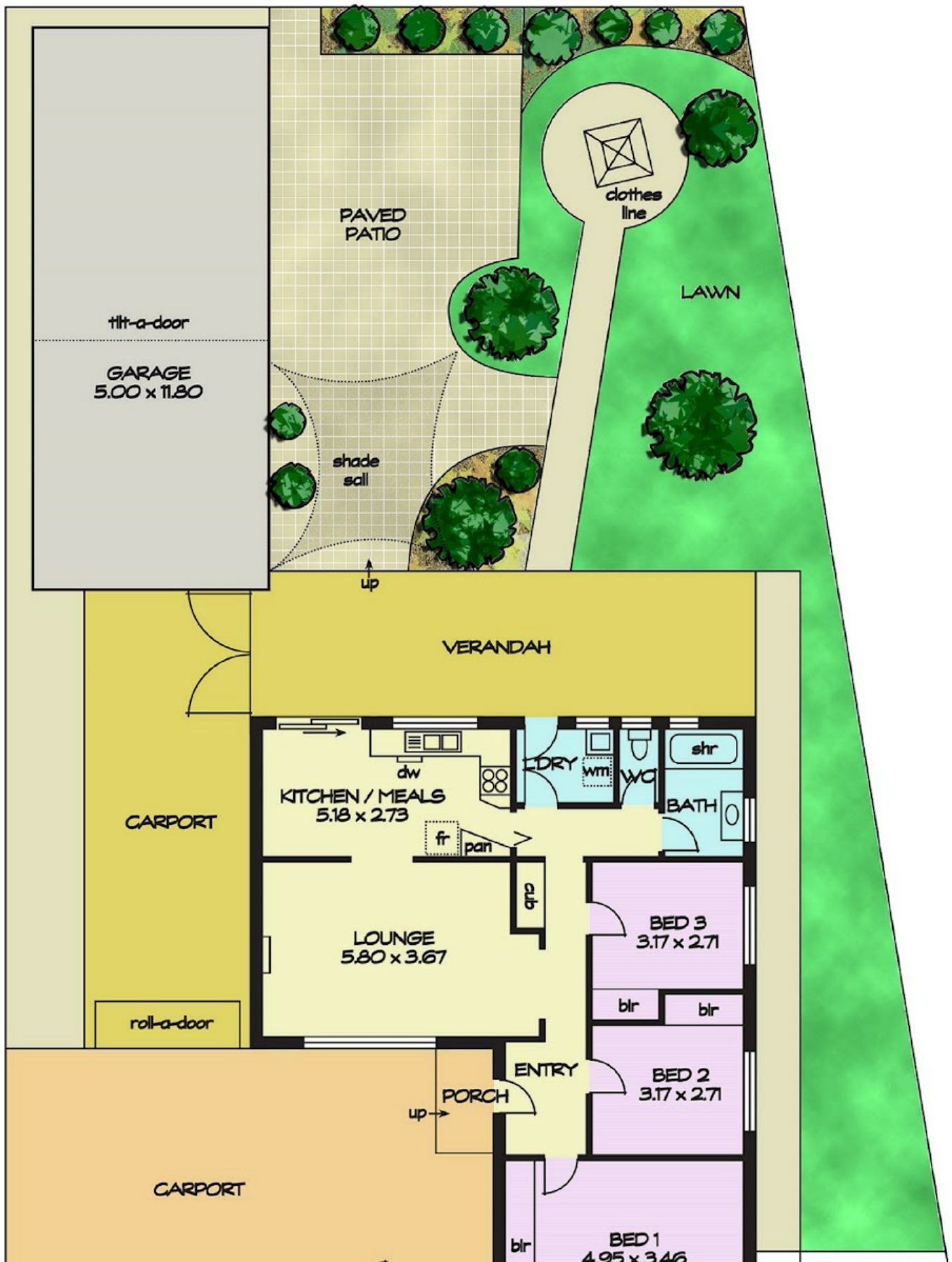

Disclaimer: Please note this floor plan is for marketing purposes and is to be used as a guide only. All dimensions are estimates only and may not be exact measurements.

Minh Nguyen
 0479070072
 minh@atrealty.com.au
 www.atrealty.com.au

AREAS (approx)	m ²
LIVING:	103
CARPORT:	87
VERANDAH:	32



GARAGE	59
TOTAL	281