



## FOR LEASE

### PERFECTLY LOCATED - 2 BEDROOM FLAT IN BURLEIGH HEADS, QLD

Located on the top floor overlooking Burleigh Hill within easy walking distance to Tallebudgera Creek, the famous beaches of Burleigh and the award winning restaurants, café and shopping precinct in James Street, Burleigh Heads.

#### Property Features include

- Two Bedrooms with built in robes
- Additional sunroom
- Open plan living
- Timber floorboards throughout
- Ceiling fans throughout
- Split cycle air-conditioning to lounge
- Shared front porch area
- Original Bathroom with separate toilet

For further information and to organise a viewing of this property please contact the listing agent.

Disclaimer: Whilst every effort has been made to ensure the accuracy of these particulars, no warranty is given by the vendor or the agent as to their accuracy. Interested parties should not rely on these particulars as representations of fact but must instead satisfy themselves by inspection or otherwise.

2 BED | 1 BATH | 1 CAR

PRICE:  
\$595 per week

OPEN FOR INSPECTION:  
N/A



@realty National Head Office  
1300299377  
headofficerentals@atrealty.com.au  
[www.atrealty.com.au](http://www.atrealty.com.au)

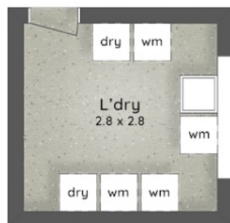

:: FLOOR PLAN  
Shared Laundry  
(Not Actual Location)



:: FLOOR PLAN  
Level 1 - 2.6m Ceiling

**POINTS OF INTEREST**

1. RAYMOND COURT
2. James Street Boutiques, Bars & Restaurants
3. Burleigh Headland
4. Burleigh Heads Beach
5. Burleigh Heads Primary School
6. Burleigh Esplanade | 7. North Burleigh S.L.S.C
8. Paddock Bakery | 9. Miami One
10. Lower Gold Coast Highway Cafes & Restaurants

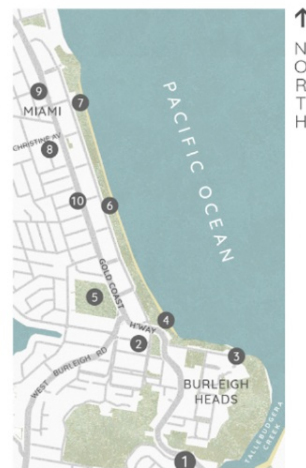

:: LOCATION MAP

RAYMOND COURT

6/10 Beelyu Street BURLEIGH HEADS

2 Bed 1 Bath 1 Car

Internal 50m<sup>2</sup> | Enclosed Patio 8m<sup>2</sup> | Total 58m<sup>2</sup>

This is not a legal document therefore all measurements and information provided is subject to survey. No permission is given to use or alter this Floor Plan without the consent of Pure Design Concepts. The overall presentation style, layout, imagery, fonts, background, colours and terminology has been originally created by PDC and is subject to strict copyright. No ownership is taken of building design. Find out more at [puredesignconcepts.com.au](http://puredesignconcepts.com.au)

**puredesign** plans for purpose

Disclaimer: Please note this floor plan is for marketing purposes and is to be used as a guide only. All dimensions are estimates only and may not be exact measurements.