



FOR LEASE

COMFORTABLE LIVING IN CLEARVIEW

Are you searching for a beautiful and comfortable home in the vibrant community of Clearview? Look no further! We are delighted to present 4a Stroud Street, a stunning property that offers both style and convenience. This spacious home is perfect for individuals or families seeking a place to call their home.

Here are the details:

Property Features:

Location: 4a Stroud Street, Clearview
Size: 400 sqm allotment
Bedrooms: 4
Bathrooms: 2
Parking: 2
Outdoor Space: Alfresco dining
Shed: 5 x 5 concreted floor

Interior Highlights:

Modern and open floor plan, providing a seamless flow between living spaces
Stylish kitchen equipped with modern appliances and ample storage
Bright and inviting living areas, perfect for relaxation and entertainment
Well-appointed bedrooms offering comfort and privacy
Elegant bathrooms main with bath
Abundant natural light throughout the home

Additional Features:

Solar panels with 5.6 inverter and 5.5w output
Roller Shutter security at front of home
Security Screen doors
Filtered water tap in kitchen
Close to local shops and public transport

Rental Details:

Rent: \$625 per week
Lease Term: 12 months
Bond: \$2500.00

4 BED | 2 BATH | 3 CAR

PRICE:

\$625 per week

OPEN FOR INSPECTION:

N/A



David McWilliams

0418745565

david@atrealty.com.au

www.atrealty.com.au

RLA: 269823

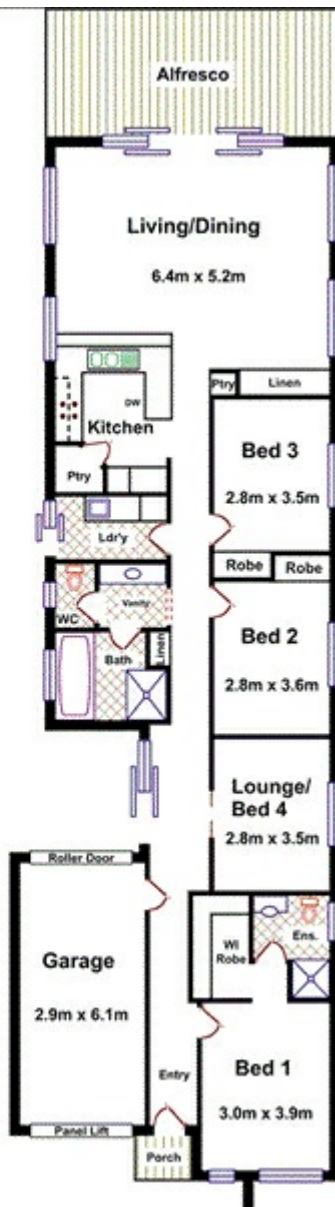

Area	M ²
Living	143.98
Garage	21.75
Alfresco	20.67
Porch	1.43
Total Approx	187.83

Please Note:
 Every care has been taken to verify the correctness of the areas and details used in this leaflet. No warranty or representation is given or made as to the correctness of the information supplied and neither the owners, illustrator nor the Agents can accept responsibility for errors or omissions. The sketch is for illustration purposes only and intending purchasers should satisfy themselves independently regarding sizes, layout and location of the property. Please check with local council that all structures are approved by council.

Disclaimer: Please note this floor plan is for marketing purposes and is to be used as a guide only. All dimensions are estimates only and may not be exact measurements.