



SOLD

GREAT VALUE INVERLOCH HOME

This sale is being facilitated by transparent negotiation. The property can sell to any qualified buyer at any time. Please contact Leo immediately to avoid missing out.

- Over 200sqm of Internal Space - Check
- Dual Living zones - Check
- Oversized Garage - Check
- Outdoor Entertaining - Check
- Home Office - Check
- Quiet Court - Check
- Low Maintenance Gardens - Check
- Huge Master Bedroom, WIR & Ensuite - Check
- Amazing Condition - Check

Welcome to your own piece of paradise in Inverloch, VIC, Australia. This modern 3-bedroom, 2-bathroom house offers everything you could want and more. The house sits on 600 square meters of land and features a great undercover outdoor entertainment area, complete with a fully fenced yard and remote oversized double garage. Inside, you'll find two large living areas, a large study with built-in cabinetry which could easily be turned into a large fourth bedroom. The kitchen is the heart of the home, featuring a dishwasher and plenty of bench space for when you're entertaining. Broadband internet availability is also included, perfect for working from home, with the added benefit of a reverse cycle aircon, you can keep cool on those balmy summer days.

This house is sure to impress, with its extremely adaptable floor plan and fresh neutral colour palette. It'll be easy to make this house your own. Location-wise, you're within walking distance of the beach and the town's many amenities, as well as close to schools and transport links.

This is a fantastic opportunity that won't last long. Don't miss out on a chance to own this stunning property - contact us today to arrange an inspection.

4 BED | 2 BATH | 2 CAR

PRICE:
\$795,000

OPEN FOR INSPECTION:
N/A



Leo Edwards
0472523445
leo@atrealty.com.au
www.atrealty.com.au

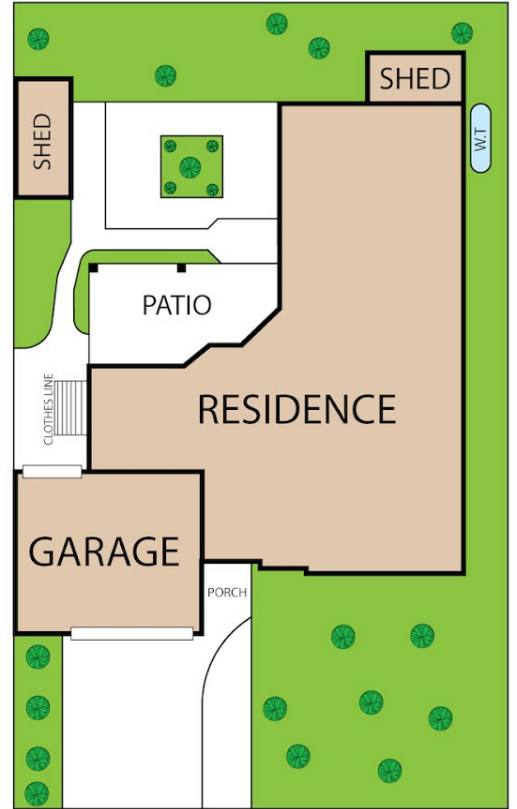

15 Dalmont Bay Court, Inverloch 3996

TOTAL APPROX. FLOOR AREA 230 SQ.M

Whilst every attempt has been made to ensure the accuracy of the floor plan contained here, measurements of doors, windows, rooms and any other items are approximate and no responsibility is taken for any error, omission, or misstatement. This plan is for illustrative purposes only and should be used as such by any prospective purchaser.



Disclaimer: Please note this floor plan is for marketing purposes and is to be used as a guide only. All dimensions are estimates only and may not be exact measurements.

Leo Edwards
 0472523445
 leo@atrealty.com.au
 www.atrealty.com.au

