

SOLD

A HAMPTONS ON A HILL

A Hamptons feel in the country with potential for dual living in this renovated family home on 4,421m² of mostly usable land with stunning views to the ocean and Surfers Paradise from the upstairs veranda and living room.

The top level lends itself to a parents retreat with 2 good sized bedrooms, spacious renovated bathroom, new kitchen with a combination of artificial stone and timber tops and stainless appliances. The flooring in the upstairs living area is a country feel timber look designed to be hardwearing ease of maintenance. The living area with plenty of windows to take in the surrounds offers access to the veranda with those stunning views to the heart of the Gold Coast.

Downstairs lends itself to many choices, granny flat, teenage hideaway, or potential letting as the two levels of this pleasant home can be locked off from one another. As you move around downstairs you find three good sized bedroom, expansive bathroom, kitchen and hideaway laundry. This lower level also has modern finishes like upstairs and once again we find the timber look floors in the traffic and living areas.

Since the current owners took over, there has been some extraordinary landscaping taken place with garden beds added around, cosy fireplace area, dry creek with bridge and soothing yard areas to explore and for the kids to have fun in. Additionally, the back near 90m boundary borders the Narang State Forrest which is full of walking tracks and mountain bike tracks, if you know where to go. As you enter the drive through the electric gates, to the left there is handy workshop and carport with additional storage on the end for the mower.

So many options with this home on the hill with views.

- 5 Bedrooms
- 2 Extremely good sized bathrooms
- 2 Modern kitchens
- Upstairs and downstairs living
- Ceiling fans in multiple rooms
- Veranda with views to the ocean and city
- Extensive landscaping

5 BED | 2 BATH | 2 CAR

PRICE:
\$1,420,000

OPEN FOR INSPECTION:
N/A



Tony Brown
0418961500
tonybrown@atrealty.com.au
www.atrealty.com.au



GROUND FLOOR PLAN



FIRST FLOOR PLAN

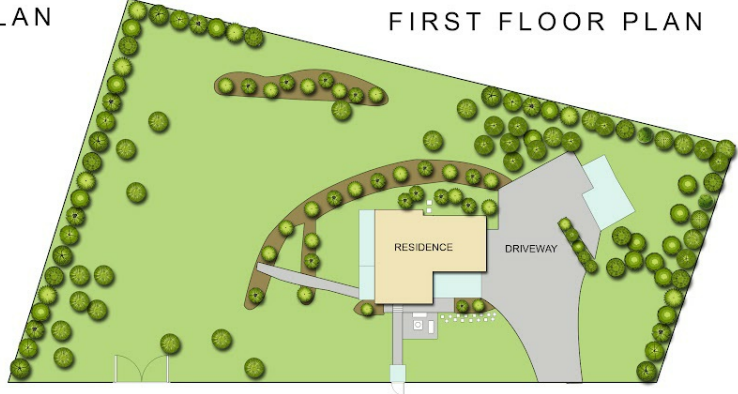

SITE PLAN

The floorplan and site plan are indicative only and not to scale, all measurements indicated may not be accurate. All buyers must do their own investigations into the accuracy of these plans.

Disclaimer: Please note this floor plan is for marketing purposes and is to be used as a guide only. All dimensions are estimates only and may not be exact measurements.