

10 BINDANA AVENUE, SALISBURY PARK, SA, 5109



SOLD

FANTASTIC FIRST HOME OR INVESTMENT OPPORTUNITY

Welcome to Salisbury Park, where you'll find this well maintained solid brick family home situated on a generously-sized 680 square meter block. The wide 21 meter frontage approx could make this allotment perfect for subdivision, subject to the necessary consents.

The home comprises 3 bedrooms, all with built in robes a bright spacious living area, Kitchen with a casual meals area, bathroom plus 2 toilets and a tiled laundry.

This property also features a fully fenced rear yard with an established garden, undercover entertaining area and two garden sheds.

The home boasts plenty of extras such as solar panels, window shutters, ducted cooling, Split system AC, and carport with automatic roller door and plenty of off street parking.

This fantastic home is perfect for first home buyers, investors or anyone looking for a well-priced property in an up-and-coming suburb. Located close to schools, shops, sporting facilities, and public transport, this property is sure to tick all the boxes.

Enquire now to arrange an inspection and take the first step towards making this lovely home your own. RLA 269823

3 BED | 1 BATH | 1 CAR

PRICE:
\$520,000

OPEN FOR INSPECTION:
N/A



Andrew Giles
0414696936
gilesproperty@atrealty.com.au
www.atrealty.com.au
RLA: 269823

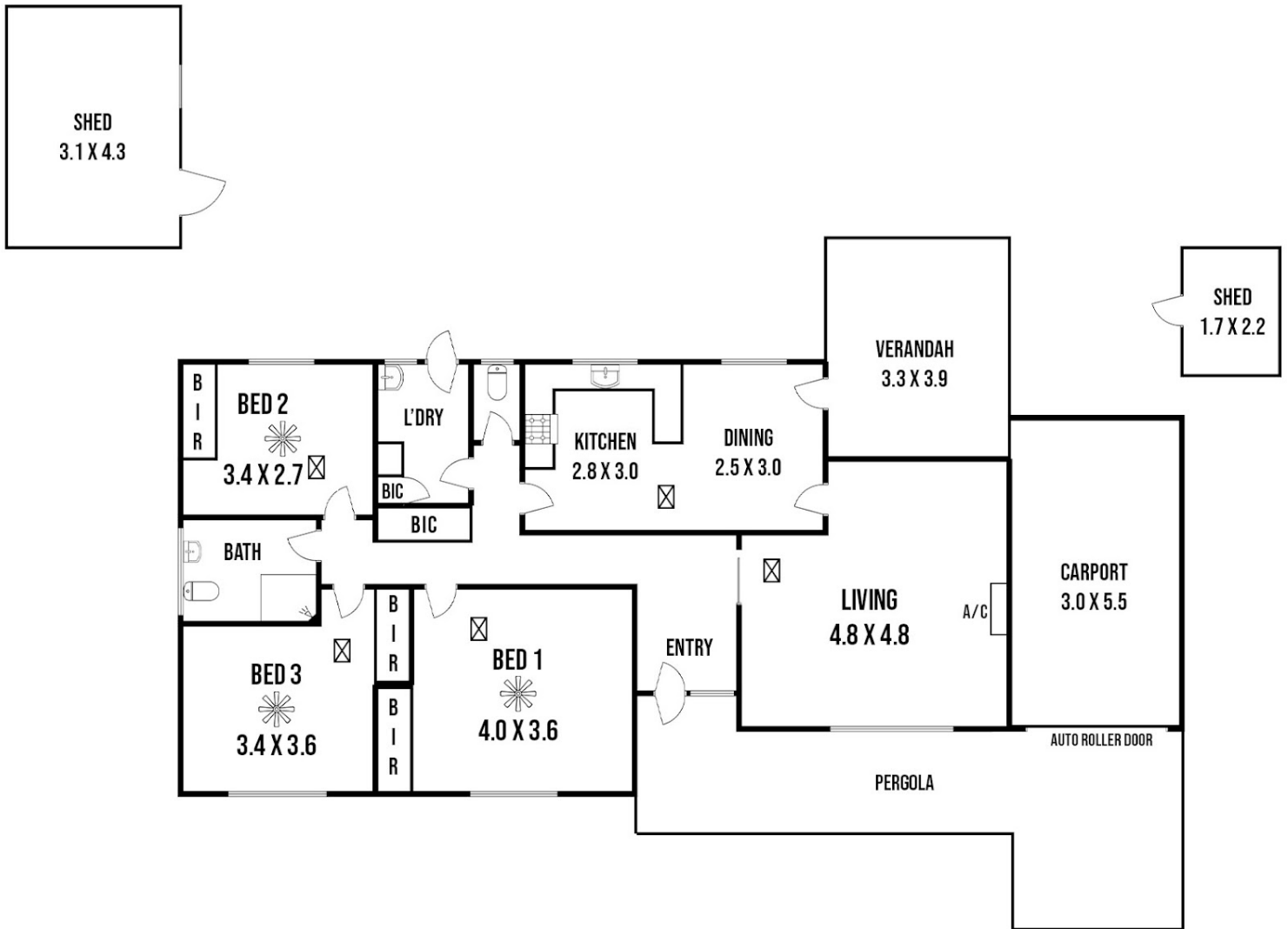

10 Bindana Avenue, Salisbury Park, SA 5109

Disclaimer: The information & figures obtained within this document has been compiled from information provided by vendor & sources that we believe are reliable. No warranty is given to their accuracy & all figures are subject to change without notice.

Disclaimer: Please note this floor plan is for marketing purposes and is to be used as a guide only. All dimensions are estimates only and may not be exact measurements.