



SOLD

EXECUTIVE ENTERTAINER

End Date Sale

Offers close 4pm Monday 6th November 2023 (unless sold prior)

Entre

Situated in a quiet cul-de-sac in one of the best pockets of Wilson, just a few minutes walk from the river, this two-storey executive home boasts three living areas.

External

The property has a commanding street appeal and is situated on a low-maintenance 386sqm block. The lucky new owner will enjoy a high quality of living without having to worry about maintenance. The alfresco and backyard provide ample space to enjoy the outdoors, while the water feature adds a touch of tranquility. Additionally, the property boasts a lime tree and rosemary plants.

Essence

The layout is designed in such a way that it almost guarantees to fulfil everyone's requirements.

For those who love to entertain, an open-plan kitchen-family-meals area is an exciting feature.

Those who love movies and sports will enjoy the great-sized theatre room with curtains that give that warm cinema feel.

An upstairs area that could have many uses such as another zone for watching TV, a family study space, a home gym, a kid's play area or if enclosed become a 4th bedroom.

The master suite boasts a spacious ensuite with an oversized shower and walk-in robe. The balcony adds an extra touch of appeal to this superb space.

The secondary bedrooms are both double-sized with built-in robes.

Spacious laundry with lots of storage.

Enviros

If you're looking for a lifestyle location, it doesn't get much better than this! This property is

3 BED | 2 BATH | 2 CAR

PRICE:

\$1,060,000

OPEN FOR INSPECTION:

N/A



Jarrad Eaton

0403267251

jarrad@eatonproperty.com.au

eatonproperty.com.au

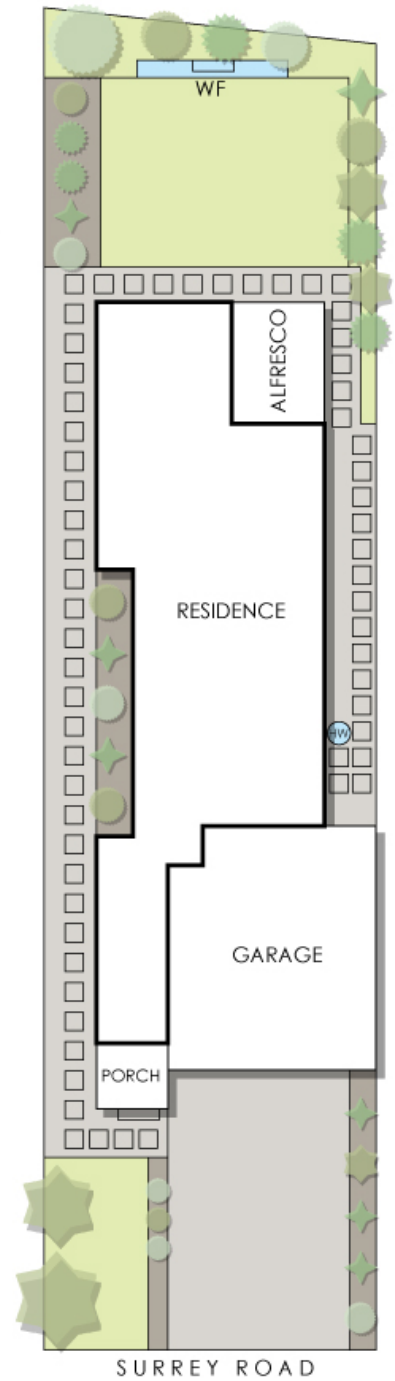

Disclaimer: Please note this floor plan is for marketing purposes and is to be used as a guide only. All dimensions are estimates only and may not be exact measurements.

Residence 219m² | Garage /Store 44m² | Porch 5m² | Alfresco 10m² | Balcony 12m²
Total Area 290m²

Jarrad Eaton
0403267251
 jarrad@eatonproperty.com.au
 eatonproperty.com.au

This floorplan is for illustration purposes only to show the layout of the property. Whilst every effort has been made to ensure the accuracy of this floor plan, all measurements and any other details shown are an approximate interpretation. Measurements are not guaranteed and may vary slightly for any error, omission, misrepresentation or use of any other information. Not to be used for any other purpose.
 www.crbcreative.com.au

@crealty