



SOLD

MODERN 2 BRM HOME STAND ALONE UNIT WITH OWN FENCED GARDENS, WALK TO BEACH QUIET-ONLY \$315,000

@realty are privileged to present an Investor's Dream or Perfect First Home!

Welcome to your modern standalone 2-bedroom unit that exudes the charm of a house with its stylish porch entry and dedicated fenced yard.

Nestled in a sought-after beach suburb, just 5 minutes' drive from Innisfail CBD, this residence offers convenience at its finest. You'll be close to major shopping centers, medical facilities, schools, and recreational spots, making this the ideal location for both investors and first-time home buyers.

Step into the inviting open-plan living area with clean and crisp tiled floors, where refreshing ocean breezes flow through full-length windows, creating a tranquil atmosphere. The modern kitchen, complete with a glass top cooker, oven, range hood, breakfast bar, pantry, and ample storage, is ready to inspire your culinary creations.

You'll enjoy peace of mind in this fully air-conditioned and fully screened unit, along with the added bonus of a security system. The soft and cozy carpeted bedrooms and stylish bathrooms offer the perfect sanctuary for relaxation and comfort.

Entertain guests on the covered outdoor area, offering privacy and serenity, while the remote access garage and secure lock-up workshop provide ample space for storage and hobbies.

Immerse yourself in the beauty of the yard, where your creative gardening ideas can flourish, all set in a quiet and safe neighbourhood. With beach walks, the ocean air, and the potential to cultivate your very own veggie patch, this residence is truly a haven for well-being.

Don't miss out on this great opportunity! Contact the agent now to arrange a viewing or a convenient video/facetime walk-through. Unlock this unique gem before it's gone.

2 BED | 2 BATH | 1 CAR

PRICE:
\$315,000

OPEN FOR INSPECTION:
N/A



Jean Laterre
0437696969

jean.ccr@atrealty.com.au

www.atrealty.com.au

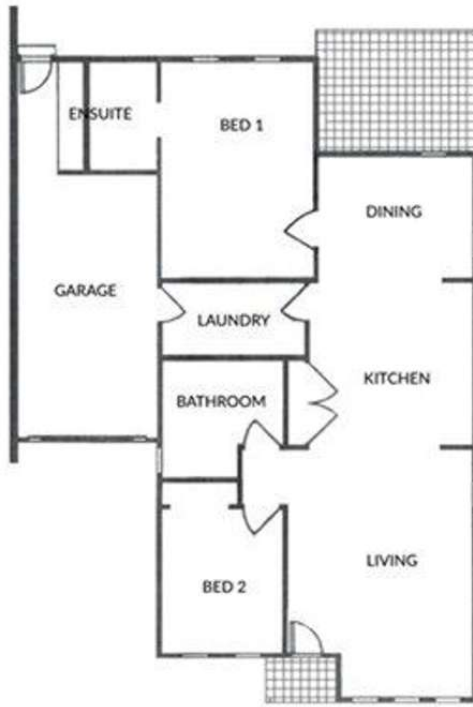

Disclaimer: Please note this floor plan is for marketing purposes and is to be used as a guide only. All dimensions are estimates only and may not be exact measurements.