



SOLD

LARGE WONTHAGGI FAMILY HOME

For more detailed information on this property including high-res photos, videos, virtual tours visit the dedicated property website at 42wallacestreet.com

Welcome to 42 Wallace Street, North Wonthaggi, VIC, Australia! This stunning four-bedroom house is situated on a huge 2,005 sqm parcel of land and is the perfect place to call home.

From the moment you arrive, you will be in awe of this property's extensive features and high-end finishes. Boasting a whopping 343 sqm floor area, this home is sure to please. Open the front door to be welcomed by a light and spacious living and dining area, with modern floorboards, plush carpets, and plenty of natural light. The home is filled with quality features throughout, such as built-in wardrobes, a study, built-in appliances, ducted heating and cooling, and three zoned living areas.

A modern kitchen is equipped with quality appliances, including a dishwasher, plenty of cupboard space and a pantry. There is also a great covered outdoor entertainment area, complete with a fully-fenced backyard and outdoor seating. Enjoy the added convenience of secure parking and storage in the oversized remote garages, plus a range of eco-friendly features such as solar panels.

Living in North Wonthaggi, you will have access to all the amenities you need. With convenience stores, schools, and shops all nearby, you will never be far from what you need. Enjoy the sunny beaches of the Bass Coast, just a short drive away, or take a ride along the popular rail trails.

This home really does have it all and is ready for you to move in and make it your own. Don't miss out on this opportunity to make 42 Wallace Avenue your dream home.

4 BED | 2 BATH | 4 CAR

PRICE:
\$890,000

OPEN FOR INSPECTION:
N/A



Leo Edwards
0472523445
leo@atrealty.com.au
www.atrealty.com.au

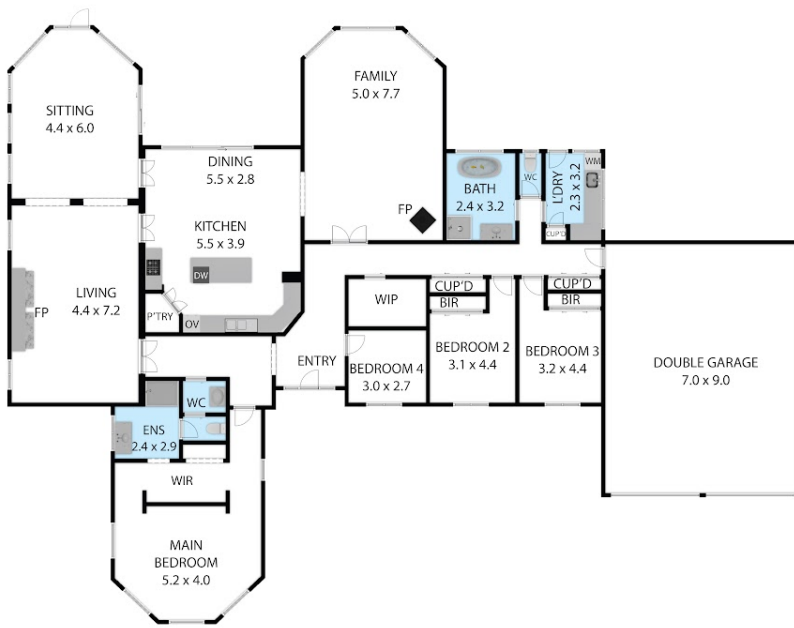

42 Wallace Street, North Wonthaggi 3995

TOTAL APPROX. FLOOR AREA 343 SQ.M

Whilst every attempt has been made to ensure the accuracy of the floor plan contained here, measurements of doors, windows, rooms and any other items are approximate and no responsibility is taken for any error, omission, or misstatement. This plan is for illustrative purposes only and should be used as such by any prospective purchaser.



Disclaimer: Please note this floor plan is for marketing purposes and is to be used as a guide only. All dimensions are estimates only and may not be exact measurements.

Leo Edwards
0472523445
leo@atrealty.com.au
www.atrealty.com.au

