



SOLD

YOUR FAMILY HOME IN CAMBRIDGE

Nestled in the highly prestigious Cambridge Estate, an area synonymous with both reputation and demand, is this expansive 5-bedroom family haven on an enormous parcel of land (approx. 799sqm).

Immediately upon entry, you are greeted by sunlit rooms, thanks to generous windows inviting in the daylight. The living rooms are spacious and effortlessly flow into the open plan kitchen and meals area.

The home offers five sizable bedrooms, each embodying the overarching theme of space and comfort. The master bedroom stands out, not just in its enormous size but also with its full ensuite and walk-in-wardrobe.

Two distinct living zones ensure that families have their spaces to enjoy. Ducted heating and evaporative cooling systems ensure that the home remains a comfortable residence, regardless of the season outside. Outdoors, an undercover area awaits, perfect for entertaining.

Situated within Cambridge Primary School Zone, this property is perfect for families after a combination of space, location, and modern comforts.

Convenience is at its peak with the property's proximity to Pacific Werribee Shopping Centre, Hogans Corner Shopping Centre, Tarneit West Shopping Centre, IGA and an assortment of schools and parks. Reach out today for a viewing!

5 BED | 2 BATH | 2 CAR

PRICE:
\$800,000

OPEN FOR INSPECTION:
N/A



Samuel Hogan
0401315234
samuel@atrealty.com.au
www.atrealty.com.au

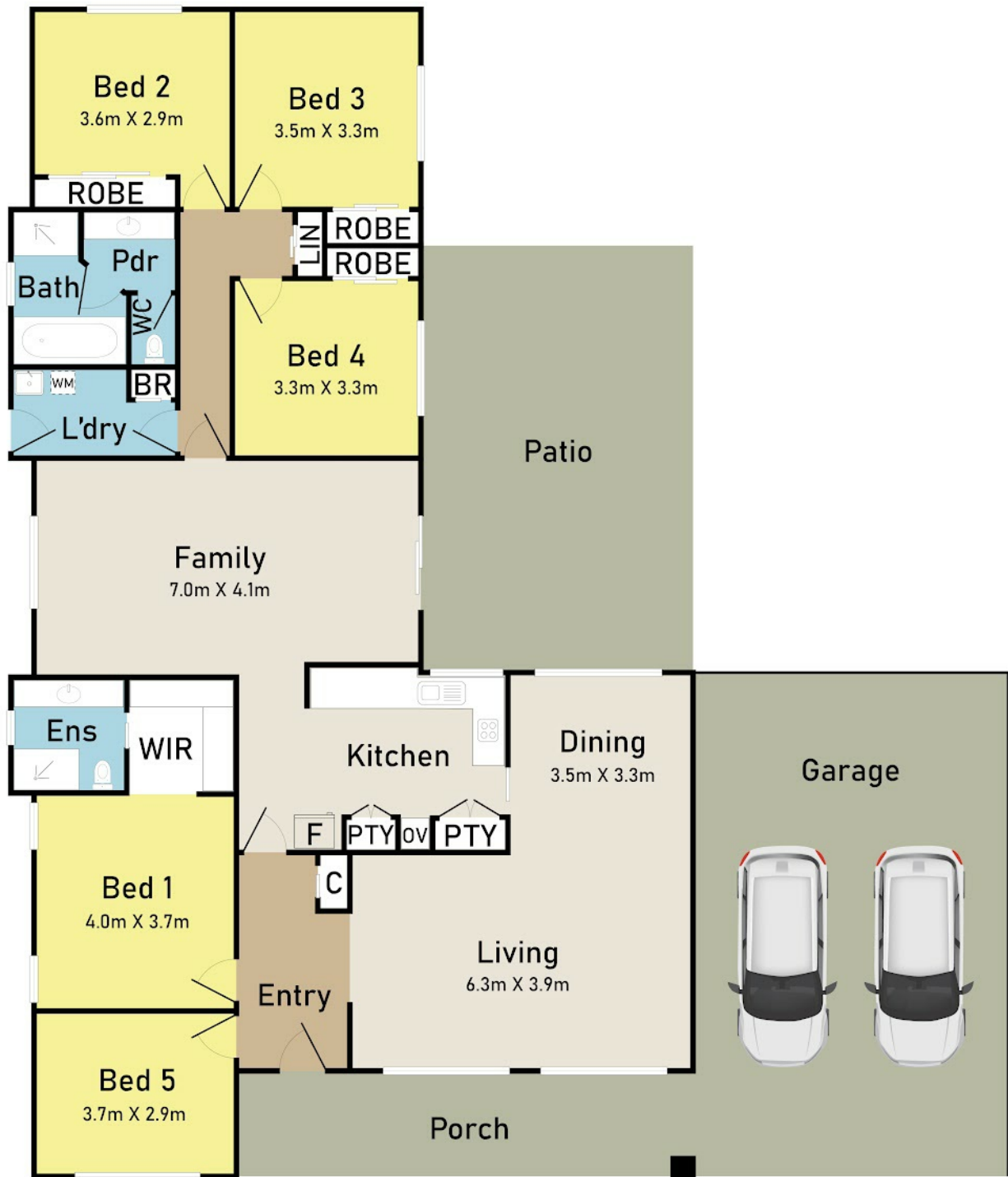

2 Dawe Court Hoppers Crossing

* Dimensions are approximate and for illustrative purposes only



Disclaimer: Please note this floor plan is for marketing purposes and is to be used as a guide only. All dimensions are estimates only and may not be exact measurements.