



SOLD

BRIBIE BEACHSIDE LIFESTYLE!

Delightful Beach Home - Great Location

An easy stroll to everything "Wonderful Woorim" has to offer.

Located on the corner of Oxley Way and Clayton Street; this home is in a superb location. The beach, cafe's, restaurants, supermarket, shops, Surf Club, medical centres, pharmacy, Pub, dog beach, recreation parks, golf club and 4x4 beach access are all in close proximity.

This original Bribie Beach Shack has been updated during its life and boasts 3 generous bedrooms, beautiful hardwood timber floors, low maintenance garden and safe secure yard.

The location doesn't get much better than this for beachside living on the island.

Features include:

- * Superb location
- * 3 generous bedrooms
- * Stunning hardwood timber floors
- * Lounge room
- * Open kitchen
- * Front porch
- * Rear patio
- * Split system air conditioning
- * Ceiling fans in all rooms
- * Dual access to secure corner block
- * Single Garage
- * Double Carport
- * Storage shed
- * Hard stands for extra parking of cars, boats or caravans
- * Water the gardens from the Spear Pump
- * Easy stroll to all amenities Woorim has to offer including the beach

For a private inspection call Woorim resident and local agent Ross Hincksman 0417687379

3 BED | 1 BATH | 3 CAR

PRICE:
\$775,000

OPEN FOR INSPECTION:
N/A



Ross Hincksman
0417687379
rossh@atrealty.com.au
www.atrealty.com.au

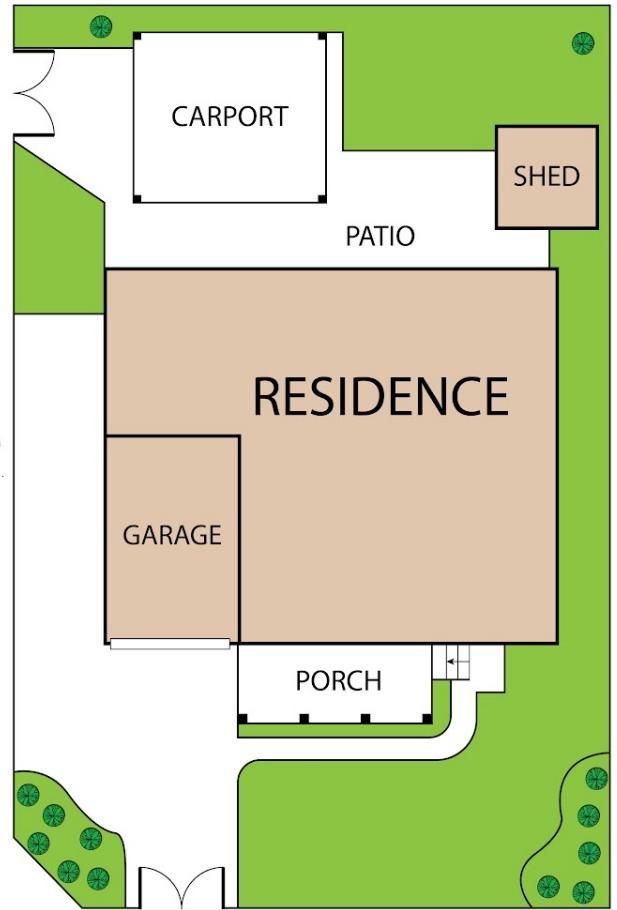
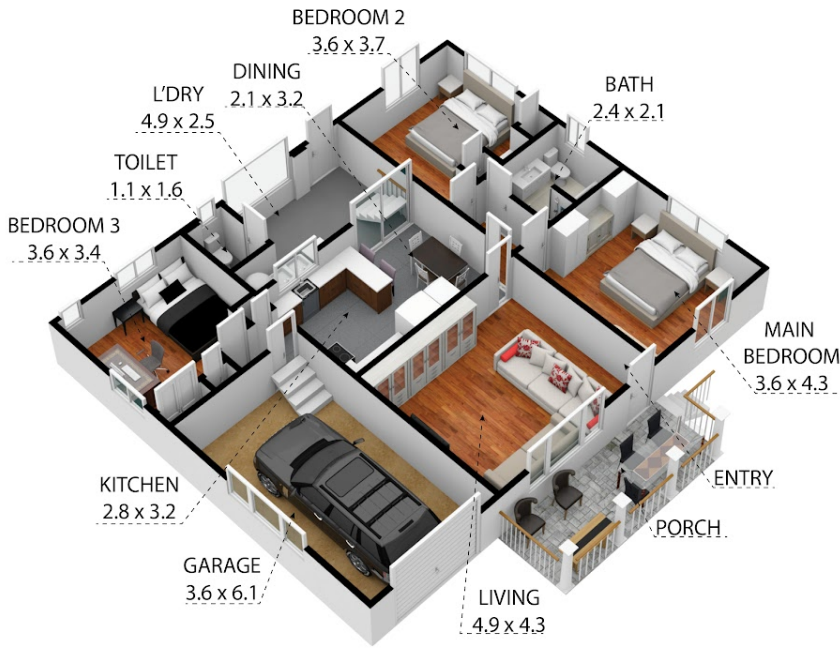

2 Clayton Street, Woorim 4507
TOTAL APPROX. FLOOR AREA 142 SQ.M

Whilst every attempt has been made to ensure the accuracy of the floor plan contained here, measurements of doors, windows, rooms and any other items are approximate and no responsibility is taken for any error, omission, or misstatement. This plan is for illustrative purposes only and should be used as such by any prospective purchaser.

Disclaimer: Please note this floor plan is for marketing purposes and is to be used as a guide only. All dimensions are estimates only and may not be exact measurements.