

2/33 VIVIAN DRIVE, ROKEBY, TAS, 7019



SOLD

BRAND NEW HOME - DUE FOR COMPLETION DECEMBER 2023

Brand New House and Land Package New Homes area - Perfect 1st Home or Investment
We are excited to offer this brand new home to market offering large open plan living areas, dream kitchen and in the ever popular new homes area of Rokeby, close to the new Glebe Hill Shopping Centre.
Quality is assured with local Builders Taylor and Beeson completing the project from start to key handover.
First home owners grant of \$30,000 applies to this home for eligible purchasers and further incentives available, call Ben for further information.

Due for completion in December this year, this house and land package offers every amenity for the growing family all on a generous 2 strata allotment with a good sized strata landholding.

- Master Bedroom with walk in robe and separate ensuite
- Second and third bedrooms are double's with built in robes
- Large kitchen with stone benchtops
- Sundrenched north facing lounge and kitchen
- Double glazed windows throughout
- Reverse cycle airconditioning
- 12 year structural Guarantee
- Six star energy rated home
- LED lighting throughout
- Private rear yard
- Fully landscaped
- Fully fenced

Please get in touch for further information on our upcoming House and Land Packages using the provided links below.

3 BED | 2 BATH | 0 CAR

PRICE:
\$609,000

OPEN FOR INSPECTION:
N/A



Ben Palmer
0417556731
benpalmer@atrealty.com.au
hobarthomes.com.au

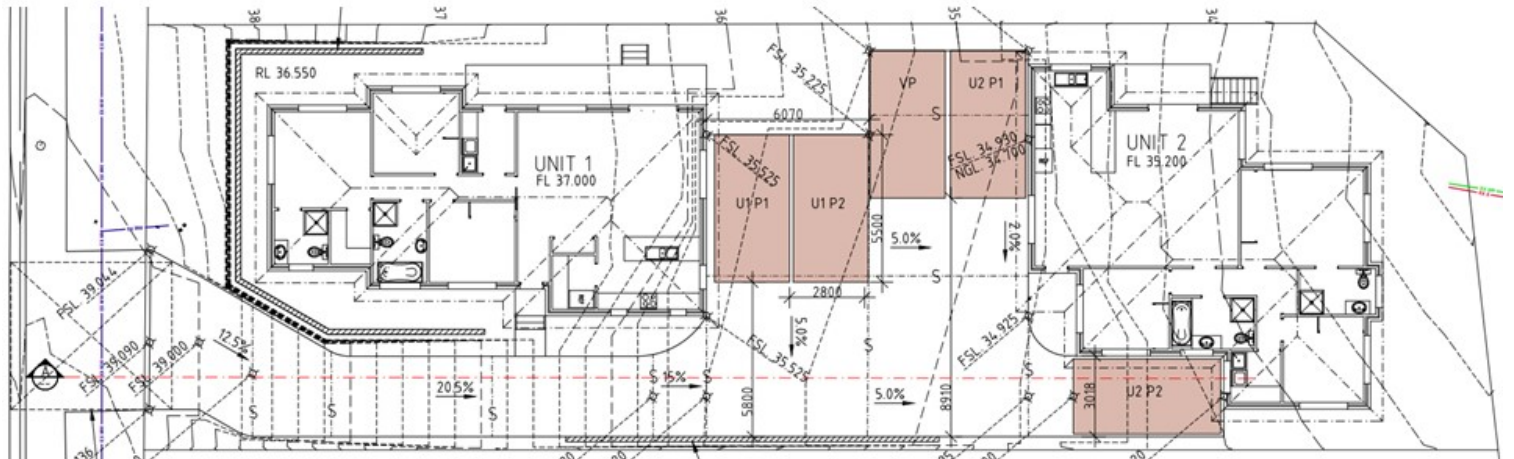
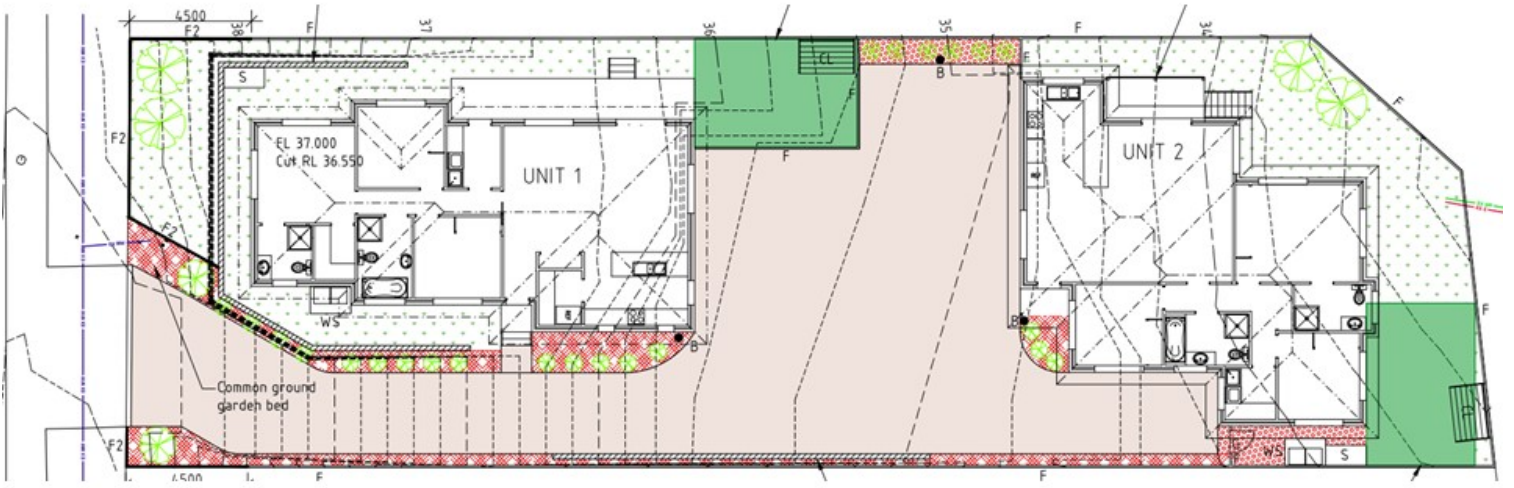

Disclaimer: Please note this floor plan is for marketing purposes and is to be used as a guide only. All dimensions are estimates only and may not be exact measurements.