



SOLD

DESIRABLE LOCATION MEETS REFINED LIVING

For the selective buyer who understands the allure of location, 22 Rosebery Street is a treasure waiting to be discovered. This splendid three-bedroom home, situated on an expansive 485sqm block, is ideally located in Altona Meadows – just a stroll away from top-notch amenities and effortlessly close to the freeway.

Upon entering, be greeted by a generously spaced kitchen and dining area that flows seamlessly into a lounge room, punctuated with high vaulted ceilings that impart a sense of grandeur and openness. Its recent renovation is showcased in a beautifully appointed bathroom, exuding modern luxury and style.

Each of the three inviting bedrooms offers peaceful slumbers and restful mornings. And for those who value outdoor serenity, the generous land size ensures ample space for leisure, landscaping, or potential expansions, subject to council approval (STCA).

Location-wise, families will appreciate being within walking distance to Altona Meadows Primary School. On your days off, enjoy a serene walk at the AB Shaw Parklands, a shopping spree at the Central Square Shopping Centre, or take a short commute to the city from the nearby Laverton Railway Station. Everything you need is right at your doorstep.

Whether settling in for a cosy night at home or hosting vibrant gatherings, this home blends functionality and elegance for a harmonious living experience. Secure your piece of this enviable locale today.

3 BED | 1 BATH | 1 CAR

PRICE:
\$641,500

OPEN FOR INSPECTION:
N/A



Samuel Hogan
0401315234
samuel@atrealty.com.au
www.atrealty.com.au

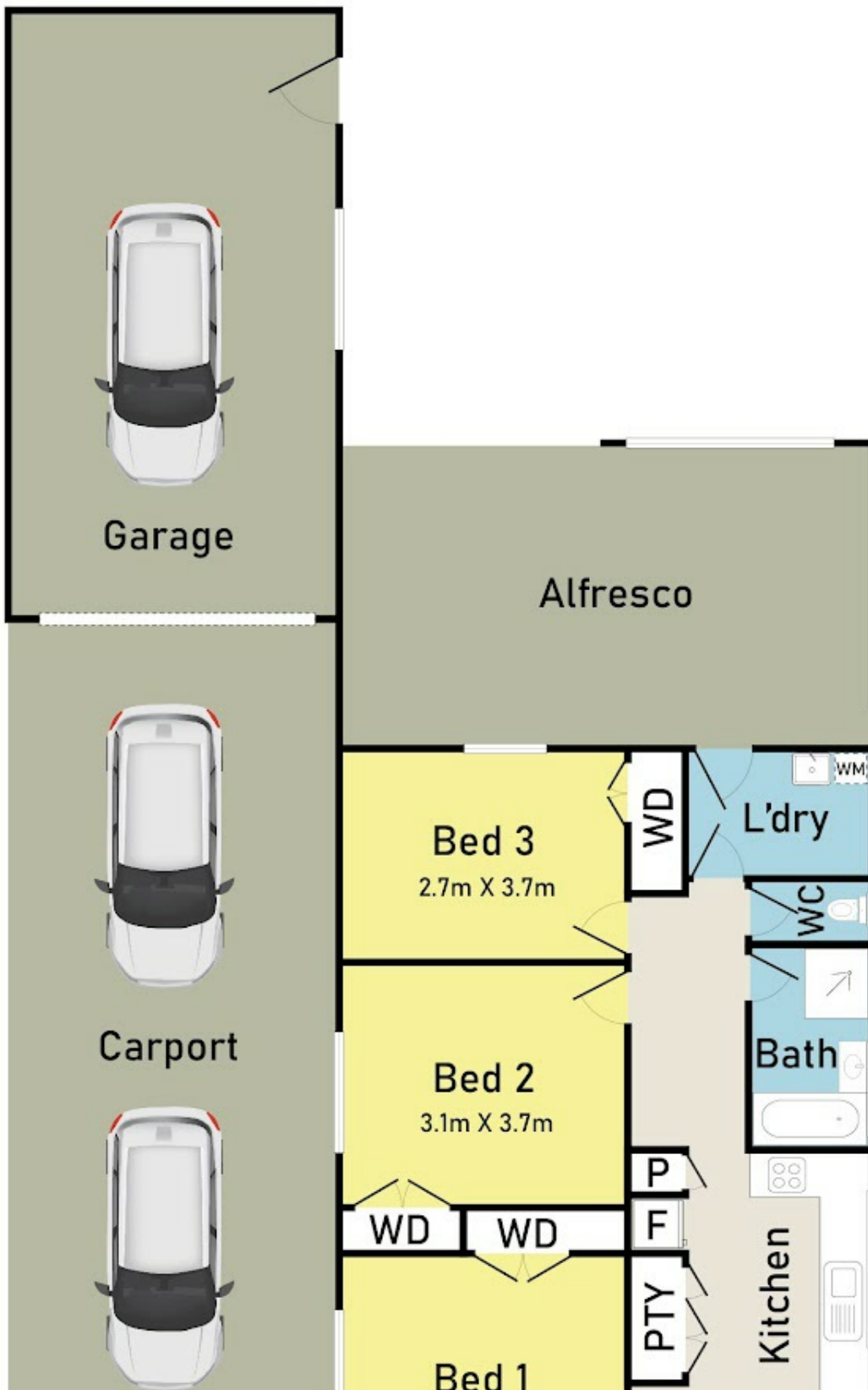

Disclaimer: Please note this floor plan is for marketing purposes and is to be used as a guide only. All dimensions are estimates only and may not be exact measurements.

Samuel Hogan
 0401315234
 samuel@atrealty.com.au
 www.atrealty.com.au

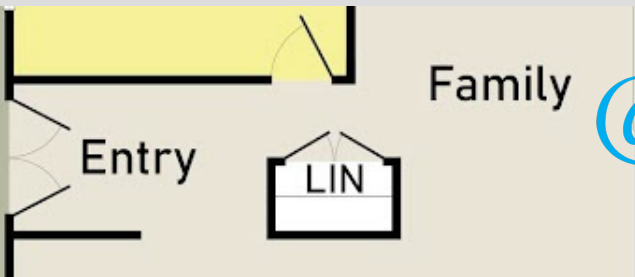



22 Rosebery St Altona Meadows

* Dimensions are approximate and for illustrative purposes only



@realty