



SOLD

LOW MAINTENANCE LIFESTYLE IN ALTONA MEADOWS

Set in the peaceful suburb of Altona Meadows, this 2-bedroom home radiates charm and presents a harmonious blend of low maintenance living and a convenient lifestyle. Be it first home buyers, downsizers, or investors, this property resonates with every buyer profile seeking their next high-quality home.

The property greets you with a welcoming façade. Upon entry is a separate lounge adorned by a bay window, capturing the essence of bright natural light. Nearby, a large master bedroom, a generous second bedroom, an expansively-designed bathroom and a generous laundry. Around the corner awaits a spacious open plan kitchen and meals area, the kitchen providing plenty of benchtop and cupboard space. Other stand-out attributes include a single car garage with drive through access to the backyard, solar panels, efficient ducted heating, evaporative cooling, and the home's recent updates with fresh paint, new flooring throughout and blinds.

Location truly is key! Nestled in proximity to Altona Green Primary School and Altona Green Park, daily conveniences are just a stone's throw away. The Central Square Shopping Centre delivers on all shopping needs, while the Cheetham Wetlands and Skeleton Creek add a touch of nature to the locale.

2 BED | 1 BATH | 1 CAR

PRICE:
\$575,000

OPEN FOR INSPECTION:
N/A



Samuel Hogan
0401315234
samuel@atrealty.com.au
www.atrealty.com.au

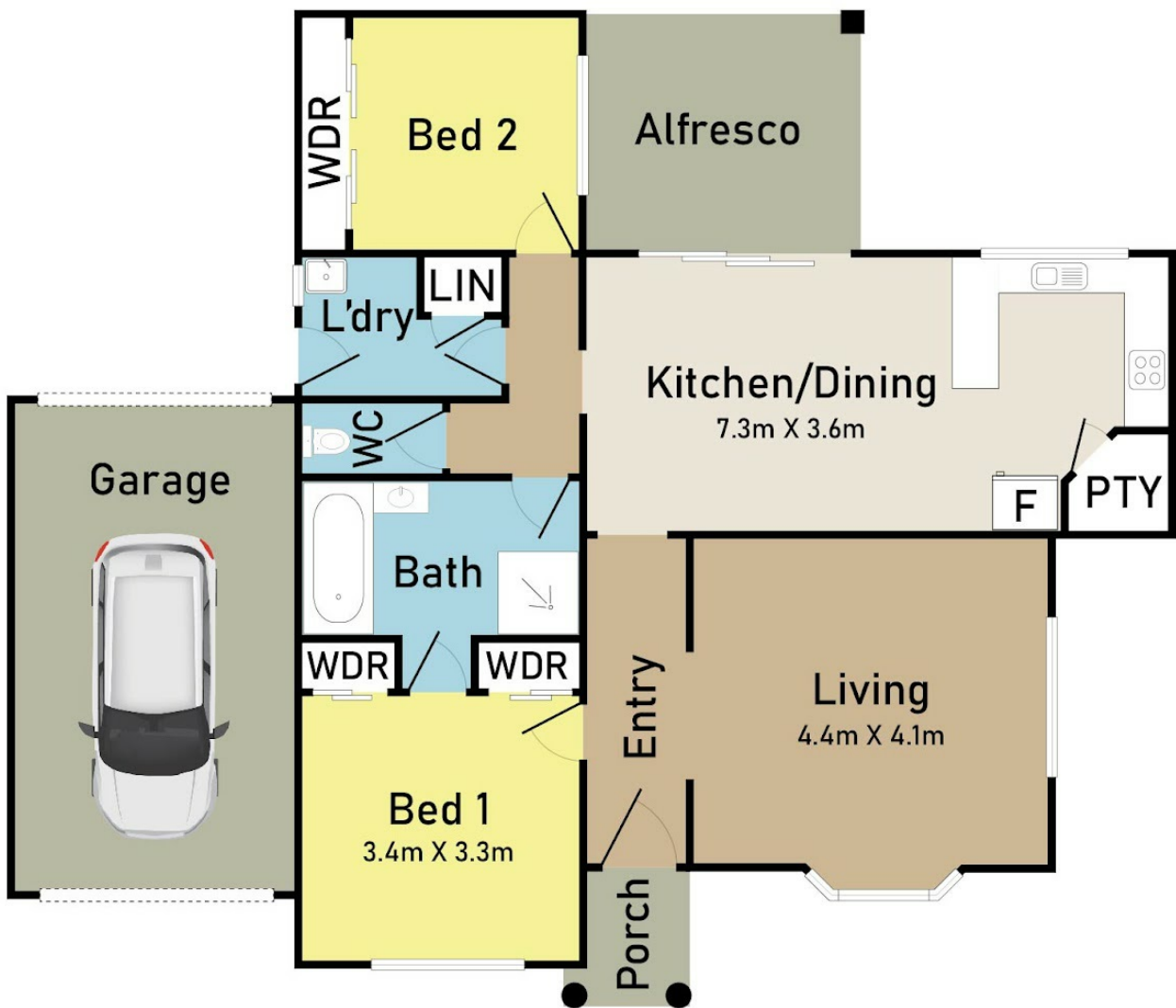

3 Chiarella Pl Altona Meadows

* Dimensions are approximate and for illustrative purposes only



@realty

Disclaimer: Please note this floor plan is for marketing purposes and is to be used as a guide only. All dimensions are estimates only and may not be exact measurements.