



SOLD

"SITUATED IN A VERY PRIVATE LOCATION, A 6-YEAR-OLD HOME WITH A SHED ON A LARGE 2,413M2 BLOCK".

This as new 4-bedroom home boasts all the features of modern living. With 4 bedrooms, plus an office and open plan living. The Two car garage will accommodate a four-wheel drive vehicle, offering plenty of space to maneuver a large caravan on the 2,413.00 Square Meters of land. The small creek "Crows Nest Creek" is on the lower side of the southern boundary. There has been no issue with flooding to any of the homes along the small creek.

Across from the Cul- de- sack is "Apple Gum Walk "near "Bullocky's Rest". A small footbridge crosses the creek and one can walk along the meandering creek which follows the Crows Nest township north/east perimeter, leading to "Hartmans Park" One will be fascinated by the bushland showing the native wildlife and amazing rock formations. This track is well-maintained for locals and tourists alike!

The property is very secluded and only a street away from the shopping center, IGA supermarket, dentist, and cafes./ (5mins walk)

As you enter the house, you can't help but be impressed by the modern features throughout. With many built-in cupboards and wardrobes, this home is sure to impress. The study provides the perfect space for you to work from home or to study. There is also broadband internet and pay TV, available for your convenience.

The kitchen is full of modern features to make cooking your favorite meals a breeze. Instant gas cooktop, electric wall oven, and dishwasher, plenty of bench space, and sleek modern appliances.

The master bedroom is the perfect retreat from your busy day, boasting views of the trees outside, with its walk-in robe and ensuite
Two Private balconies. One faces north and catches the morning sun and the other balcony faces south and attracts cool breezes in the summer months.
Lots and lots of storage space under the home.
This is a well-insulated (walls, ceilings, and under the floor) home, naturally cool and a split

4 BED | 2 BATH | 2 CAR

PRICE:
\$550,000

OPEN FOR INSPECTION:
N/A



Yvonne Bradley
0408181146
yvonne@atrealty.com.au
www.atrealty.com.au

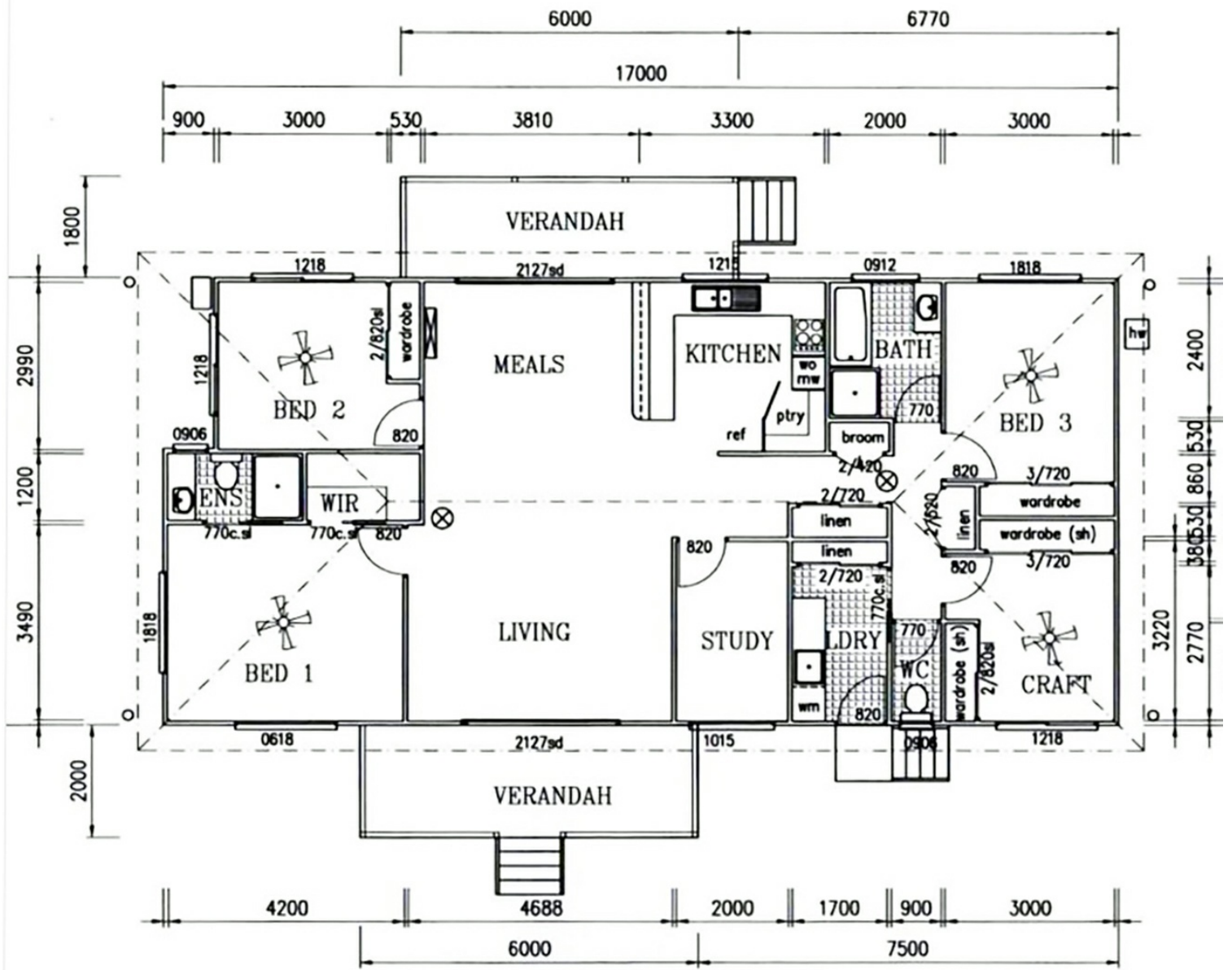

FLOOR PLAN

Disclaimer: Please note this floor plan is for marketing purposes and is to be used as a guide only. All dimensions are estimates only and may not be exact measurements.