



# SOLD

## SOLD BY ROBYN HUNT REAL ESTATE

Capturing stunning valley views, and backing onto picturesque countryside, this dual-level property is the perfect fit for those seeking to balance convenience and space with tranquility.

Dive into the lap of relaxation with your very own in-ground swimming pool that soaks in the unobstructed rural views. Whether it's a morning swim or weekend poolside gatherings, this oasis is just the place for rejuvenation and entertainment.

A cleverly designed floor plan, spread over two levels, allows separation and scope to cater for a variety of living, or work-from-home, needs.

Features of the home include:

- \* Ducted cooling and heating
- \* New flooring and fresh paint in the living, dining, entry/ hallway and kitchen
- \* Deck with stunning views adjacent to the kitchen/meals area
- \* Separate office/study
- \* Built-in wardrobes in the three upstairs bedrooms
- \* Large double garage offering ample storage for your vehicles and more
- \* Sensational views that create a sense of space and privacy that's truly rare to find!

With a massive backyard for gardening that also provides a nice spot for kicking a ball, and distant mountains as your backdrop, the possibilities for outdoor enjoyment are endless on this 2,219m<sup>2</sup> block.

Take leisurely strolls and enjoy the peaceful atmosphere, all while being just a conveniently short drive away from essential amenities, schools, and entertainment options.

Tucked away in a peaceful cul-de-sac, experience a lifestyle free from the hustle and bustle of everyday life. Wake up to the sight of hot air balloons drifting by and later watch the sky change through a kaleidoscope of colours as the sun sets. This haven offers a quiet retreat that you'll love coming home to.

Do not delay – call Robyn Hunt today on 0448 448 758 to arrange your inspection.

4 BED | 2 BATH | 2 CAR

PRICE:  
\$800,000

OPEN FOR INSPECTION:  
N/A



**Robyn Hunt**  
0448448758  
robyn@atrealty.com.au  
[www.atrealty.com.au](http://www.atrealty.com.au)

# 14 Sanctuary Court, Goonellabah



4



2



2

INTERNAL: 250m<sup>2</sup> EXTERNAL: 36m<sup>2</sup>



GROUND FLOOR



FIRST FLOOR

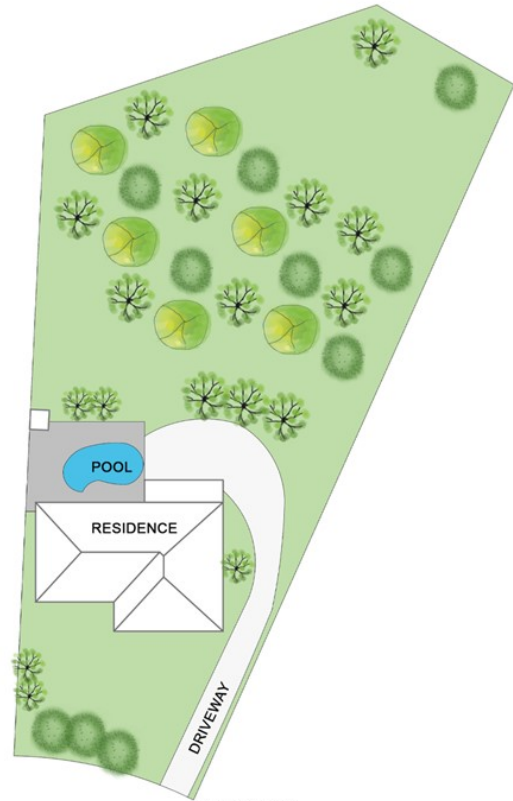

SITE PLAN  
(NOT TO SCALE)

Disclaimer: Please note this floor plan is for marketing purposes and is to be used as a guide only. All dimensions are estimates only and may not be exact measurements.