



SOLD

DISCOVER YOUR DREAM HOME IN DROUIN: 4 BEDS, 3 LIVING, HOME OFFICE, 2 BATHS, 4 CARPARKS, 750M2 OF LAND!

Welcome to your forever home in Drouin, VIC - a beautiful, family-friendly town nestled in the hills of the Gippsland region.

This stunningly spacious and modern four bedroom, two bathroom house is situated on a generous 749.98 square meter allotment, making it the perfect place to call home.

The floor area provides plenty of space for the whole family, with an expansive open plan living and dining area. The kitchen is a chef's delight, with modern appliances and plenty of bench space and butlers pantry, perfect for unloading the groceries straight from the car.

The bedrooms are all generously sized, with the master complete with an ensuite and walk-in wardrobe. Private balcony to enjoy the views over the lake. All remaining bedrooms are fitted with built-in wardrobes, providing ample storage space for all your needs.

The house is complete with 3 Living areas, a home office, a large family bathroom, a separate toilet upstairs and powder room down stairs, a spacious laundry, and plenty of storage.

Step seamlessly through the stacker doors to the outdoors, you will find an expansive backyard, complete with an undercover entertaining area. The established fully enclosed garden and the lawn provide the perfect place for children and pets to run freely and play. The shed comes complete with a Mancave including a wood fire, workshop and room for a car. The carport provides an undercover area for a car, caravan or trailer, with through access to the shed.

Features-

- Designer kitchen with extensive walk in pantry and stone bench tops
- 3 separate living areas, study/possible 5th bedroom
- Main bedroom including private balcony with a beautiful view
- Ducted Vacuum system
- 7.5 x 6m shed with 3.5m wide roller door and power
- Exclusive access to the Jackson's View Country Club with pool and gym

4 BED | 2 BATH | 4 CAR

PRICE:
\$915,000

OPEN FOR INSPECTION:
N/A



Mel Ahearn
0409183763

mahearn@atrealty.com.au

atrealtypropertysalesgippsland.com.au



FIRST FLOOR



GROUND FLOOR

FLOOR PLAN

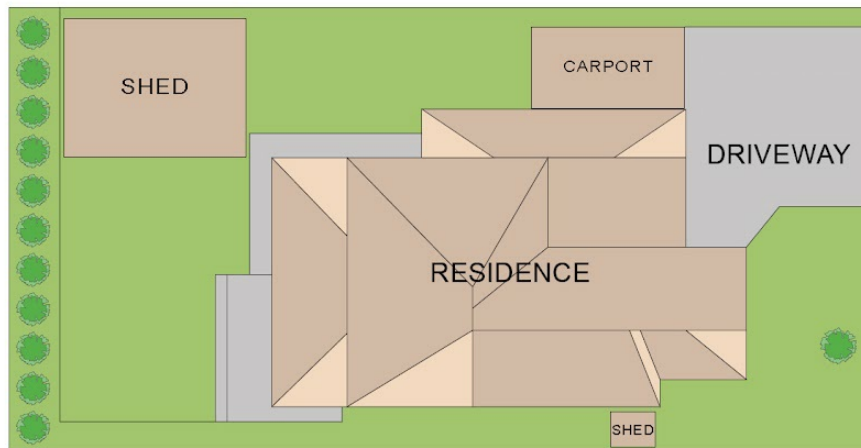

SITE PLAN

11 WATERVIEW CLOSE, DROUIN

Disclaimer: Floorplan is for illustration only, prospective purchasers are advised to make their own enquiries.



Disclaimer: Please note this floor plan is for marketing purposes and is to be used as a guide only. All dimensions are estimates only and may not be exact measurements.