



SOLD

STRONG CASHFLOW + 6% RETURNS + CAPITAL GROWTH, A HUGE 2 BED + STUDY 120 SQ MTR UNIT, CENTRALLY LOCATED IN ROBINA.

INVESTORS DON'T miss this huge 2 bedroom, 2 bathroom apartment, to live in or offering exceptional rental returns, in the quiet leafy area on the edge of Robina, a walk to Robina Town Centre, Robina High School, Hospital, Train Stations and M1 Highway access.

THE TOP 5: Are looking for an Investment Property for:

- 1: CASHFLOW AND ADDITIONAL INCOME.
- 2: GROWTH & CAPITAL GAINS.
- 3: REDUCE TAX TO PAY OFF DEBT FASTER.
- 4: POSITIVE GEARING.
- 5: GROW A PORTIFILO OVER TIME.

PLEASE CALL ME TO SEND YOU MORE OPTIONS.

The large open plan living, dining and kitchen area flows beautifully out to the large balcony, which fills the home with plenty of natural light. Enjoy the cool breezes while sipping on your morning coffee in your unit or below in the coffee shops

Please note virtual furniture has been used in images

Key Highlights:

- Rent \$680 PW- On level two
- 2 spacious Bedrooms + study nook
- 2 bathrooms
- Lift access from carpark
- Ensuite with a spacious shower and double vanities
- Air-conditioning in living area and master bedroom
- Modern kitchen

2 BED | 2 BATH | 1 CAR

PRICE:
\$600,000

OPEN FOR INSPECTION:
N/A



Gregg Hewitt
0413442229
gregg@atrealty.com.au
Gregg Hewitt

6/52 Acacia Court Robina

Approximate Total Floor Area 120m²

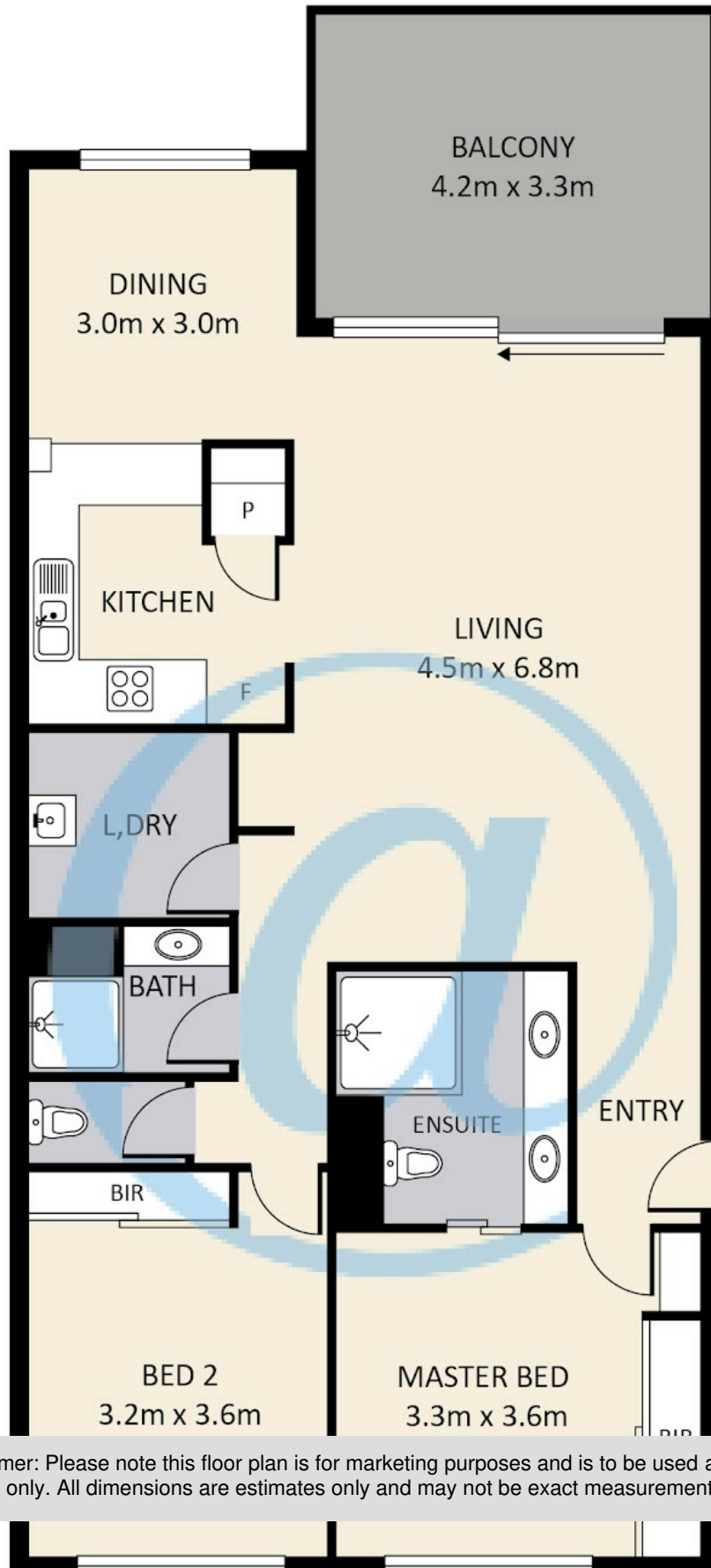

Disclaimer: Please note this floor plan is for marketing purposes and is to be used as a guide only. All dimensions are estimates only and may not be exact measurements.

