



SOLD

ELEVATED LAND WITH VIEWS. NOW REGISTERED.

Large flat block of land with stunning views. One of the highest positions in Collingwood Park. Easy to build on vacant land is now ready for your builder to start.

Land Dimensions:
Total size: 486m²
Frontage: 16.5m
Depth: 30m

Located in Collingwood Park's premium residential estate, The Pocket. This is a rare opportunity to secure level and elevated land at this price (under \$400k).

Close to all local amenities including supermarkets, retail shopping, public transport, and easy walking distance to local primary and less than 100 metres to the new secondary college under-construction.

Take a look today as these blocks don't last long.

0 BED | 0 BATH | 0 CAR

PRICE:
\$356,000

OPEN FOR INSPECTION:
N/A



Jamie Martin
0450727195
jamiemartin@atrealty.com.au
www.atrealty.com.au



STAGE 4

LEGEND

- Area of Fill
- Area of Cut
- Design Contours
- Depth of Fill Contours
- Proposed Retaining Wall (Height shown in brackets on lower side)
- (XX.XX) Finished Design Surface Level
- Built to Boundary Location
- Future Development Lot Boundary
- Proposed Driveway Location

(Not all items in this legend may be relevant to the lot shown on this plan)

NOTES

This plan has been prepared from preliminary survey plan (SP331514) and engineering plans provided on the 06/06/2022 by Peak Urban Pty Ltd.

The current development approval for this subdivision was granted by the Ipswich City Council on the 07/04/2021 - Minor Change Application. (Approval No: 3769/2019/MAMCA)

For updates to the development approval visit: www.ipswich.qld.gov.au

At the time of publication of the original issue of this plan, the relevant authorities have not yet granted operational works approval for the proposed lot.

The purchaser should refer to the applicable development approvals for building and/or other requirements that may be applicable to the lot.

Retaining wall locations and thickness shown on this plan are diagrammatic. For detailed design information refer to the relevant earthworks drawings from Peak Urban Pty Ltd.

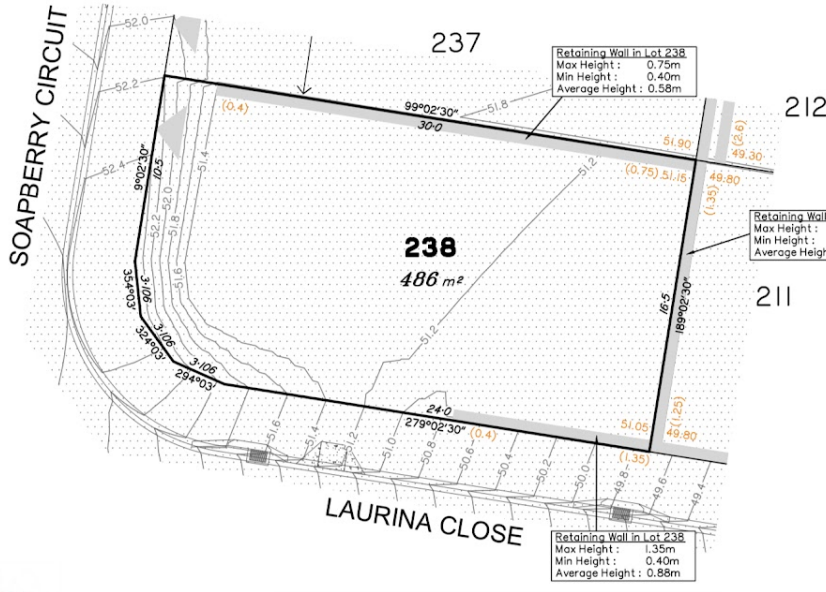

Disclaimer: Please note this floor plan is for marketing purposes and is to be used as a guide only. All dimensions are estimates only and may not be exact measurements.

