

SOLD

UNDER CONTRACT

PRICE REDUCED TO SELL NOW !!

ENTRY LEVEL APARTMENT WITH BROADWATER VIEWS IN THIS FANTASTIC 'CRYSTAL BAY' - NORTH-EAST FACING APARTMENT

Located on the 2nd floor of "Crystal Bay on the Broadwater" this beautifully presented 1 bedroom + Study / potential Bedroom 2 offers you beautiful views over the resort pool and parklands beyond to The Broadwater. You'll have to act fast as this one won't last long.

The spacious open plan living allows for easy entertaining from the inside to the outside, whilst having the stunning backdrop of The Broadwater.

Currently vacant, this apartment is ready for you to move straight in and can be sold fully furnished, so it would be ready to put it into the holiday letting pool and start earning income from the day you settle. Plus, use when you need a weekend getaway on the Gold Coast it's there for your use. Great potential returns available. Permanent rental or use the fantastic onsite managers and holiday let option, the choice is yours.

"Crystal Bay on the Broadwater" is one of the highly sought after buildings on the Golden Mile Stretch of Marine Parade, Labrador and offers resort-style living and the ultimate lifestyle with an array of café's, restaurants and the Broadwater all at your doorstep.

APARTMENT FACILITIES

- Open plan living
- Fully equipped white kitchen - matching white appliances & ample preparation space
- Master Bedroom – mirror fronted built in robe
- 2 -way bathroom with access from the master
- Dining room/Potential Bedroom 2 with built-in storage and bookshelves
- Ceiling fans throughout
- Direct access to the spacious balcony from living area and Master bedroom
- Generous 13m2 balcony with great Broadwater views
- Can be sold fully furnished (by negotiation)
- Secure underground car park

CRYSTAL BAY FACILITIES

- Large heated resort-style pool with spa
- Gym with state-of-the-art equipment

1 BED | 1 BATH | 1 CAR

PRICE:
\$576,000

OPEN FOR INSPECTION:
N/A



Francine Setchell
0408143464
francine@atrealty.com.au
www.atrealty.com.au

Unit 201, 182-192 Marine Parade, Labrador

1 Bed 1 Bath 1 Car

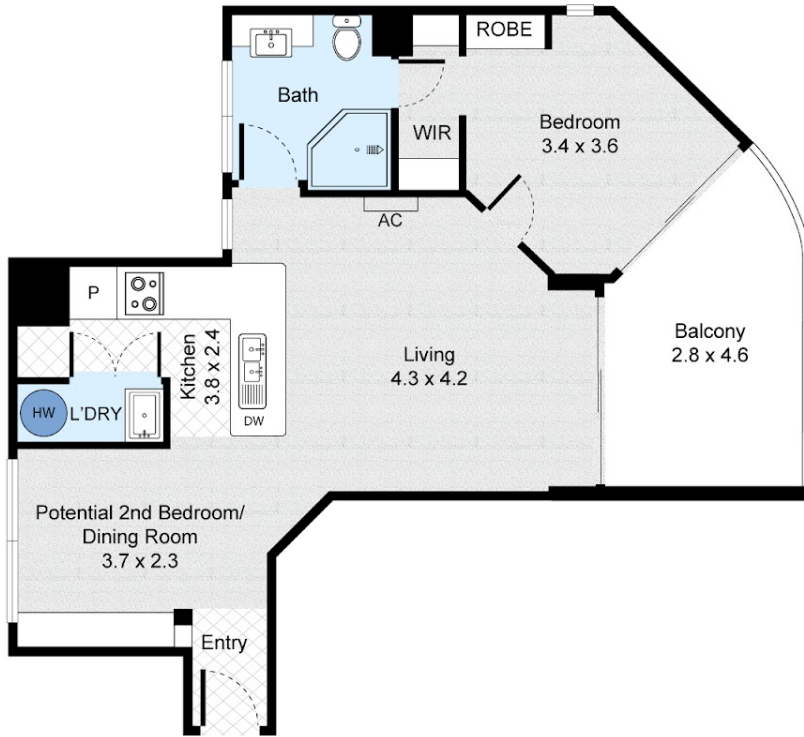

FLOOR PLAN



(Not In Position)

CAR SPACE

Internal : 61m²
External : 13m²
Total : 74m²

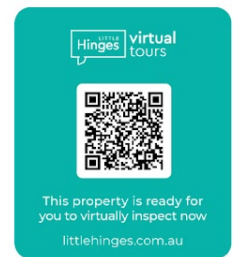

All information contained herein is gathered by Little Hinges. Whilst the scanning technology is highly reliable, we cannot guarantee its accuracy and interested parties should rely on their own enquiries.

Disclaimer: Please note this floor plan is for marketing purposes and is to be used as a guide only. All dimensions are estimates only and may not be exact measurements.

Francine Setchell
0408143464
francine@atrealty.com.au
www.atrealty.com.au

