

SOLD

SOLD BY AUDREY GOETZ

SOLD by Audrey Goetz. More urgently needed! Impressive Family Home on over 1 acre! Resort style living set on over 1 acre of usable land. An impressive family home set on over 1 acre of flat usable land, this home offers space, lifestyle and room for the whole family with all the conveniences of country living yet with a resort feel!

Conveniently located within minutes from all of the Gold Coast main amenities, attractions, and beaches in sought after Country Crescent, boasting 5 bedrooms + a study, 3 car garage + a workshop and extra carport for boats, caravans and extra vehicles, a huge resort style pool, a full size tennis court, multiple indoor and outdoor spaces, an ideal upstairs master bedroom + retreat and lots more!

Meticulously planned and built by the original owner builder, this solid brick and tile home has an ideal floor plan with all amenities and infrastructure in place. This home is bright, open and spacious and is a must to inspect.

Features Include:

- 5 bedrooms + a study
- 2 bathrooms + powder room
- 4137m2 of land, landscape, fenced and secure with a 72.6 mt street frontage
- Upstairs parents retreat including king size master bedroom with spacious ensuite with spa + generous walk in robe + parents retreat with balcony overlooking hinterland views and pool
- welcoming entrance with high feature ceiling
- open plan kitchen/ living and dining with raked ceilings and access to the spacious under roof entertaining area
- galley style large kitchen with granite bench top, two draw dishwasher, corner pantry
- huge games /media room with bar/ kitchenette with sink and fridge space which could also be converted to a granny flat
- Study/ crafts/ media area complete with desks and built in storage
- loads of storage throughout the home as well as roof storage and a cute cubby house under the stairs off the play area
- fully fitted study area ideal to work from home
- ceiling fans and air-conditioning throughout.
- full size tennis court with lights.
- covered alfresco area overlooking the fenced resort pool with decking for entertaining
- spacious seperate laundry
- 2 water tanks

5 BED | 2 BATH | 4 CAR

PRICE:
\$1,625,000

OPEN FOR INSPECTION:
N/A



Audrey Goetz
0412148078
audrey@atrealty.com.au
www.atrealty.com.au

52 Country Crescent, Nerang

5 2 3 1.02 acres

internal: 464 m² | external: 144 m² | total: 608 m²



Audrey Goetz 0412 148 078



first floor

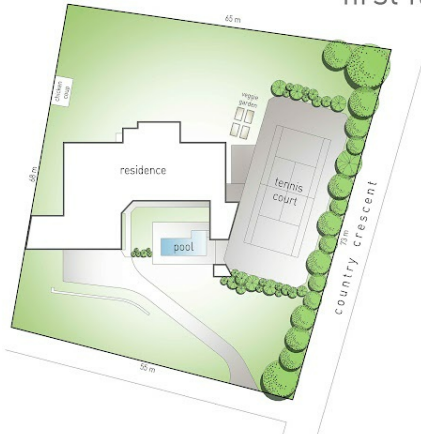

site plan

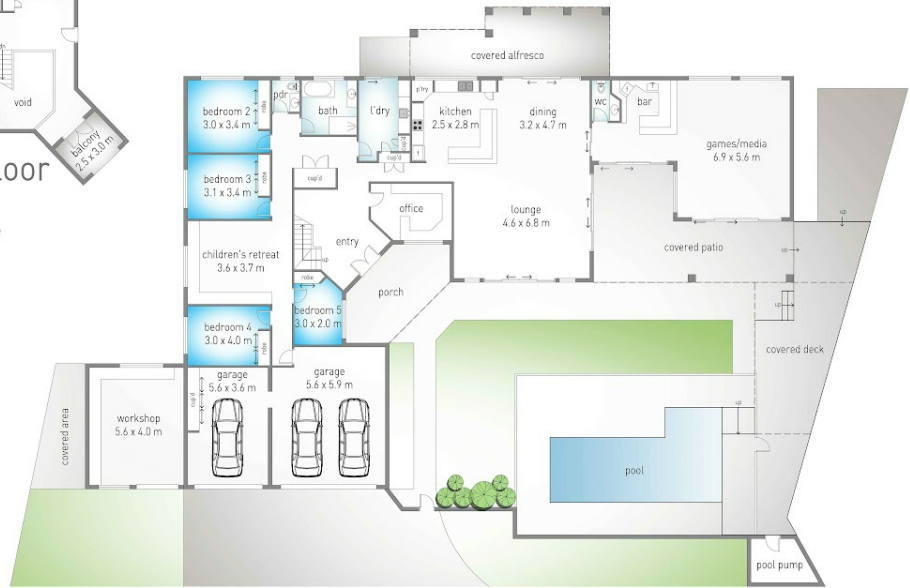

ground floor



Dimensions are approximate. All information contained herein is gathered from sources we believe to be reliable. However we cannot guarantee its accuracy and interested persons should rely on their own enquiries.



Disclaimer: Please note this floor plan is for marketing purposes and is to be used as a guide only. All dimensions are estimates only and may not be exact measurements.

Audrey Goetz
0412148078
audrey@atrealty.com.au
www.atrealty.com.au

