



SOLD

READY TO MOVE IN HARRIS BUILD 8.1 STAR HOME IN CAPE PATERSON

Why build when you can buy this turnkey stunning home that captures solar gain in winter with careful passive solar design. Excellent orientation, shading, thermally broken double glazing, air tightness and insulation, and clever use of thermal mass combine to passively heat and cool the home. These features combine to deliver great occupant comfort, with the home designed to maintain year-round temperatures between 18 – 25 degrees with minimal heating and cooling required. The colour palette and material textures complement the natural coastal landscape of Cape Paterson. 8 Stargazer is designed to house a family in a small footprint with 3 bedrooms an office, 2 bathrooms and light-filled open-plan living.

8 Stargazer is yet another bill-busting, operationally carbon-neutral home with super-low running costs, meaning the lucky new owners of this home will be comfortable in all conditions, with no gas bill, tiny electricity bills and the option to upgrade to an electric vehicle in future to eliminate petrol bills. This combination makes a household thousands of dollars per annum better off with large savings accruing over time.

Desirably located in The Cape sustainable housing estate, this level allotment of approximately 450 sqm presents a superb opportunity to build a sustainable beachside retreat of uncompromised style.

The home has been designed by Adapt Design, a specialist in sustainable house designs with construction already commenced by multi-award-winning builder, Harris Build for a November 23 completion.

The 8.1-star home has been designed to the new national construction codes (NCC) changes effective from May 2023 in terms of energy efficiency, condensation management, and liveable housing design requirements.

The home will be complemented with energy-efficient appliances, fixtures and fittings. To be constructed as per The Cape Eco village design guidelines.

3 BED | 2 BATH | 1 CAR

PRICE:
\$1,000,000

OPEN FOR INSPECTION:
N/A



Leo Edwards
0472523445
leo@atrealty.com.au
www.atrealty.com.au

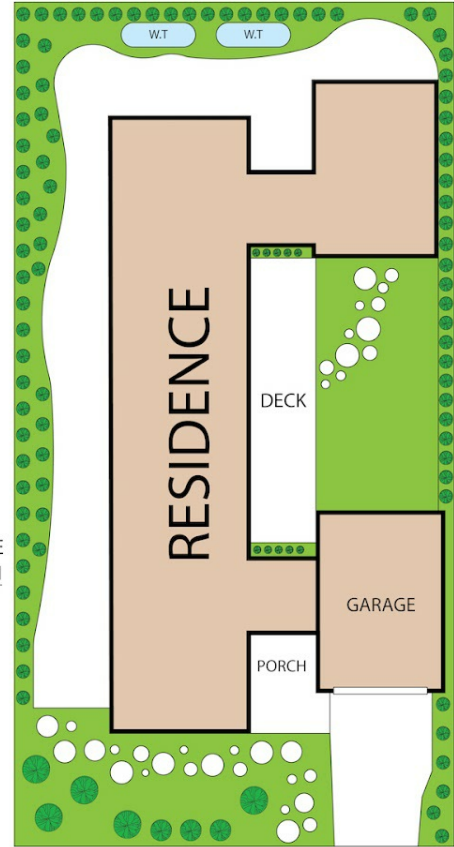
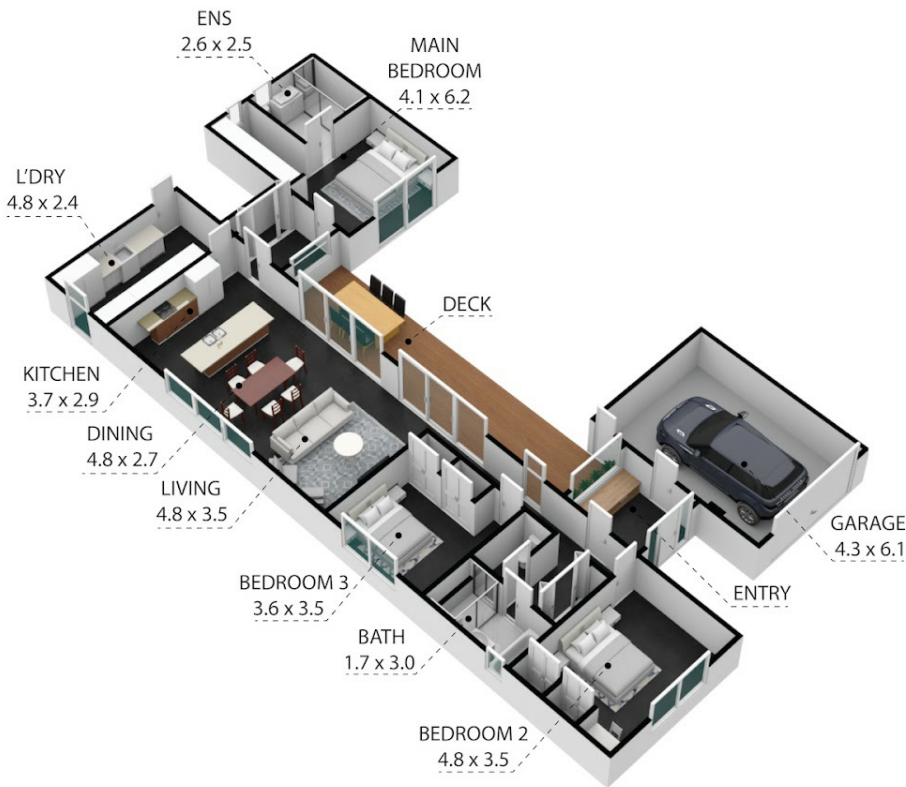

8 Stargazer Rise, Cape Paterson 3995

TOTAL APPROX. FLOOR AREA 161 SQ.M

Whilst every attempt has been made to ensure the accuracy of the floor plan contained here, measurements of doors, windows, rooms and any other items are approximate and no responsibility is taken for any error, omission, or misstatement. This plan is for illustrative purposes only and should be used as such by any prospective purchase.



Disclaimer: Please note this floor plan is for marketing purposes and is to be used as a guide only. All dimensions are estimates only and may not be exact measurements.

Leo Edwards
 0472523445
 leo@atrealty.com.au
 www.atrealty.com.au

