

SOLD

METICULOUSLY UPDATED HAVEN IN GREAT NEIGHBOURHOOD

Ready to enjoy, this cleverly designed home is packed with modern features and is ideal for buyers seeking a stress free lifestyle. It occupies a low maintenance corner block in a quiet locale, minutes from shops, transport, Teralba Park and good schools.

- Spacious lounge/dining room includes natural bamboo flooring
- Entertainers' deck with electric pizza oven and relaxing spa
- Fenced landscaped garden, dual street access for vehicles
- Sleek kitchen has 30mm Black Forest gold granite benchtops
- Light filled bedrooms, luxe bathrooms with demister mirrors
- Insulated, rewired, replumbed, ducted air conditioning/vacuum
- Smart technology, CCTV, lined shed with power, epoxy floor
- Legal height ground floor area, scope to extend living space
- Automated gate entry, on site parking for boat/van, five cars
- Central to Everton Plaza, Everton Park State and high schools

3 BED | 2 BATH | 4 CAR

PRICE:
\$675,000

OPEN FOR INSPECTION:
N/A



Bruce Tame
0419699349
bruce.tame@atrealty.com.au
www.instylerealty.com.au

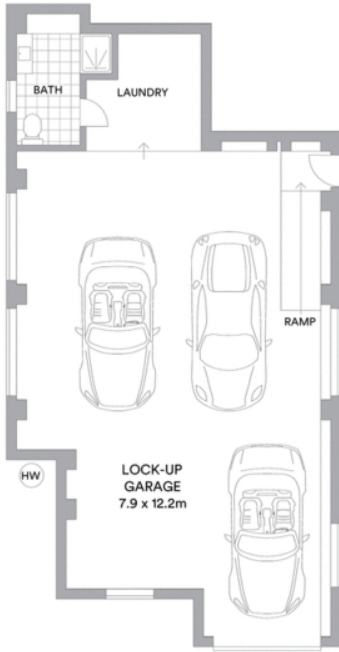

GROUND LEVEL



LEVEL ONE



Buller Street

Internal 202sqm

McGrath

Scale in metres. Indicative only. All information contained herein is obtained from sources we believe to be accurate. We cannot guarantee its accuracy. Interested persons should make and rely on their own enquiries.

Disclaimer: Please note this floor plan is for marketing purposes and is to be used as a guide only. All dimensions are estimates only and may not be exact measurements.

Bruce Tame
0419699349
 bruce.tame@atrealty.com.au
 www.instylerealty.com.au

