



**SOLD**

## ALLURINGLY UNIQUE & FLEXIBLE ENTERTAINER!

Brimming with charm and character, you will fall in love with this unique family home, positioned in a quiet loop street in one of Belconnen's most popular & central suburbs.

Floor to ceiling corner windows light the generous carpeted main lounge room, where you can picture yourself enjoying a good book by the warmth of the fireplace. The adjoining formal dining area offers sliding door access through to the deck and pergola, ideal for entertaining with friends & family.

Central to the living areas is the beautifully renovated kitchen equipped with electric cooking, double oven, dishwasher, ample storage, built-in wine rack and a servery window that opens right out to the alfresco entertaining area. The comfortable family/meals area adjoins the kitchen, for casual Sunday breakfasts as you take in the morning sun.

All five bedrooms feature built-in robes, with the master also enjoying its own private ensuite. The unique layout lending itself beautifully to extended or growing families.

Entertaining is an absolute joy out in the spacious alfresco patio and adjoining deck, all with pitched roof pergola to protect from the elements while tiled pathways lead around the magnificent established gardens.

The location is ideal - just footsteps from a nearby playground, several reputable schools, bus stops on Krefft Street and the bustling local shopping precinct for cafés, takeaway and Florey Medical Centre. You're also just a short drive from further popular schooling options in the neighbouring suburbs, as well as Lake Ginninderra and all the amenities of Belconnen Town Centre with just a few minutes further to the University of Canberra.

This wonderful home is a must-see for inspection, with sellers keen to get all genuine offers on the table!

### Features

- Ducted Gas Heating
- Evaporative Cooling

**5 BED | 2 BATH | 2 CAR**

**PRICE:**

**\$0**

**OPEN FOR INSPECTION:**

**N/A**



**Catherine Halloran**

**0490045819**

[catherine@thepropertyagents.com.au](mailto:catherine@thepropertyagents.com.au)

[www.thepropertyagents.com.au](http://www.thepropertyagents.com.au)

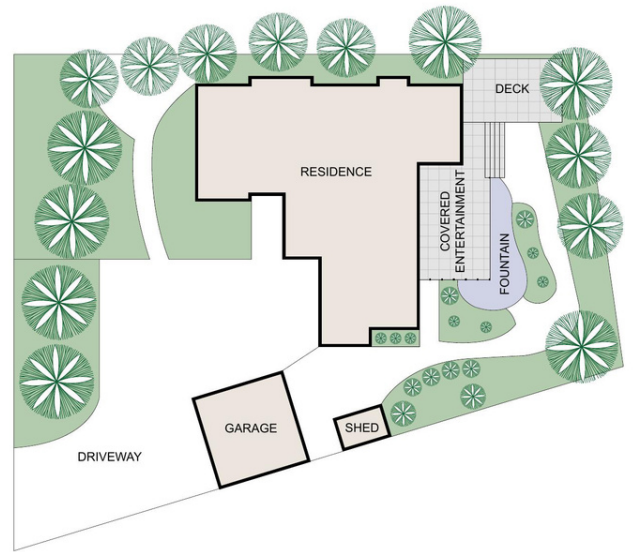

Disclaimer: Please note this floor plan is for marketing purposes and is to be used as a guide only. All dimensions are estimates only and may not be exact measurements.