



SOLD

QUIET COMPLEX IN BEAUTIFUL LOCATION!

Newly refreshed and affordably priced, this two bedroom single-level townhouse is the perfect low-maintenance option for first home buyers, investors and downsizers alike.

Fresh carpet and paint have provide a fresh and inviting interior, especially throughout the light filled combined lounge/dining space. The original kitchen - with electric cooking and ample storage - would be a breeze to refresh if you preferred something more modern - and at this price point there's plenty of room to capitalise there. Both bedrooms are generous in size with a built-in robe to the 2nd and a walk-through robe to the main, with main also enjoying ensuite access to the original two-way bathroom - complete with bath and shower, adjoining laundry room and a separate toilet.

Step outside to the low maintenance rear courtyard for alfresco entertaining or relaxing in complete privacy. A delightful space for an outdoor lounge, or to build your own mini Floriade.

As a small complex of only 10 townhouses, Jardine Terrace offers security and serenity in a quiet cul-de-sac location while still only minutes from major shops, schools and public transport links. You're within walking distance of the local playground, bus transport and Palmerston District Primary School, with just a short drive to beautiful nature reserves, further popular schools and Marketplace Gungahlin for major shops, supermarkets, dining, medical services and light rail transport into the city.

This value-packed delight is the fresh start you've been searching for, so be sure to submit your enquiry or attend the next available inspection!

Features

- 84m2 Living Space + Garage
- New Carpet & Paint Throughout
- Original Kitchen w/ Electric Cooking
- Two-Way Bathroom & Separate Laundry
- Storage to Both Bedrooms
- Electric Heating
- Linen Cupboard
- Storage Shed
- Tidy, Secure Courtyard

2 BED | 1 BATH | 1 CAR

PRICE:

\$0

OPEN FOR INSPECTION:

N/A



Catherine Halloran

0490045819

catherine@thepropertyagents.com.au

www.thepropertyagents.com.au

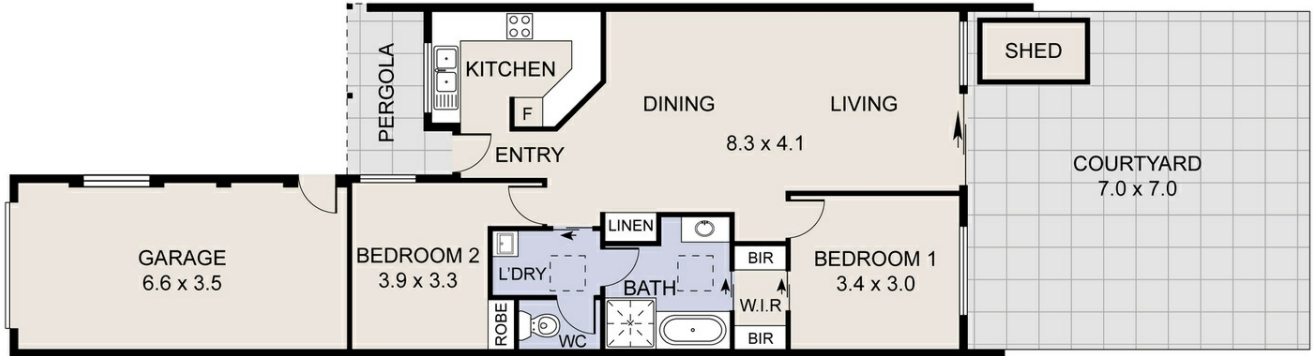

Disclaimer: Please note this floor plan is for marketing purposes and is to be used as a guide only. All dimensions are estimates only and may not be exact measurements.