



SOLD

FANTASTIC VALUE & OWNERS KEEN TO SELL!

Beautifully maintained with a lush private garden, this much loved four bedroom family home is a warm and inviting retreat for everyday comfort and effortless entertaining.

A warm and inviting formal lounge sets a welcoming tone upon entry, ideal for a relaxing evening by the fireplace. Continuing through, this sensible floorplan opens up to a generous, tiled main living space with adjoining dining, where bay windows capture an idyllic garden outlook. The tidy kitchen lends itself perfectly to both entertaining guests and casual family meals, complete with electric cooking, dishwasher, tiled splashback, ample storage and wraparound benchtop with plenty of room for breakfast bar seating.

There are built-in robes to three of the four well proportioned bedrooms with the fourth doubling as a great study or home office. A full main bathroom complete with bath, shower, mirrored vanity and separate toilet services the home, while the master includes access to a private ensuite.

Outdoor entertaining is the true highlight of this delightful home, boasting not one but two covered entertaining areas and enjoying the lush garden backdrop of your private and beautifully landscaped backyard oasis. It won't be hard to picture many happy weekends spent with family and friends within these gorgeous surrounds!

Last but not least is the double lock-up garage with auto doors, internal access and a handy workspace, together with two garden sheds for additional storage. You're just a stroll from local shops, parks, playgrounds and sports facilities, while quality public and private schools, Kippax Fair Shopping Centre and Westfield Belconnen are a short drive away.

Enjoy all the creature comforts of this well-appointed home, securely nestled in a quiet family-friendly pocket and bordered by parkland for total peace and privacy while still close to local amenities.

A wonderful future awaits the lucky new owners of this beloved family home, so don't miss your change to inspect!

Features
- Slab Heating & Gas Fireplace

4 BED | 2 BATH | 2 CAR

PRICE:
\$0

OPEN FOR INSPECTION:
N/A



Catherine Halloran
0490045819
catherine@thepropertyagents.com.au
www.thepropertyagents.com.au

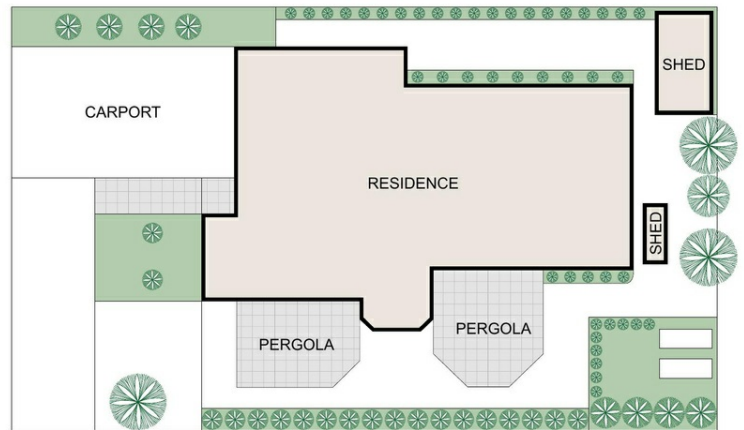

Disclaimer: Please note this floor plan is for marketing purposes and is to be used as a guide only. All dimensions are estimates only and may not be exact measurements.