

SOLD

IMPRESSIVE FAMILY HOME AWAITS! GREAT INVESTMENT TOO.

"OPEN HOME CANCELLED"

Located on 500m2 Block in Bellmere!

This modern brick home is perfect for an Investor or first home owner looking to enter the real estate market. The Bellmere State School is just around the corner and we also have the very new Bellmere Shopping Centre comprising of a huge Woolworths Store and a variety of shops. Across the road from the Shopping Centre we have The Busy Bees Child Care Centre and the 7 Eleven Petrol Station. Its all here and waiting for you to come along and purchase.

Features;

- * Solid brick & tile home finished in a semi-render
- * Lovely timber deck entry
- * A/C Master bedroom with WIR carpets and fan
- * Bedroom 2 is A/Conditioned, carpets & fans + BIW
- * Bedrooms 3 & 4 have carpets, fans & BIW
- * Stylish kitchen with modern appliances D/Washer & instantaneous hot water
- * Separate big carpeted A/C lounge room
- * Under roof Alfresco entertaining area
- * Security screens & Ceiling fans throughout
- * Air-conditioning & tiled dining/2nd living room
- * Large Internal laundry
- * 2 x 3000L Water Tank & 1 x 2000 water tank plumbed to the home
- * 22 Solar panels with 6.6kw Invertor big \$\$\$\$ savings
- * Both bathrooms and kitchen have instantaneous hot water
- * DBL Remote Lock Up Garage
- * 500m2 block with side access
- * Impressive and wonderfully kept gardens
- * Security Screens & window locks
- * Owner occupied, neat as a pin
- * Prospective Rent Return \$540 to \$550p/w

This property will not last the first Open Home so put this home at the top of your to do list this weekend, Call Mal on 0429 535 197 or come along to this Saturdays Open Home

4 BED | 2 BATH | 2 CAR

PRICE:
\$595,000

OPEN FOR INSPECTION:
N/A



Mal Lucas
0429535197
mal@atrealty.com.au
www.atrealty.com.au

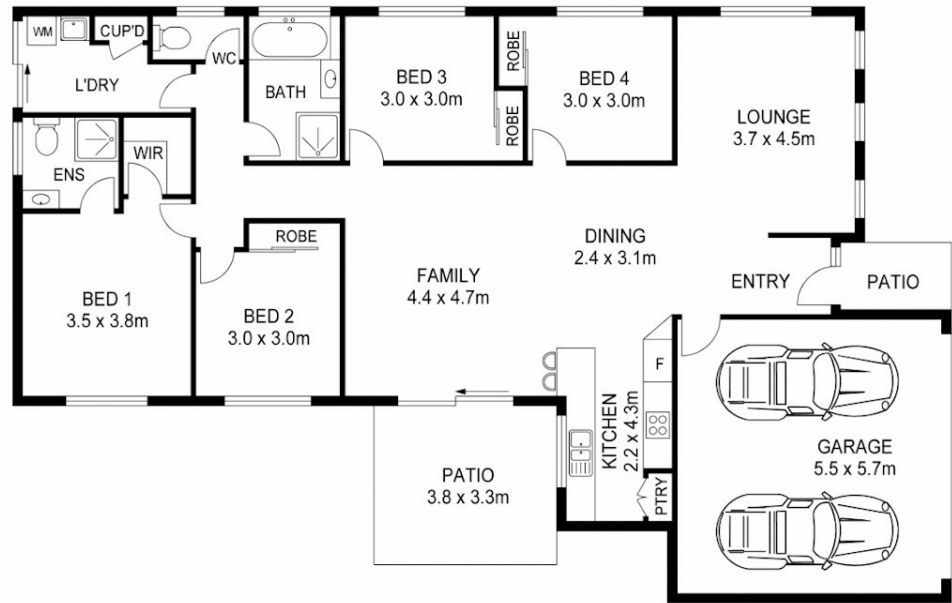
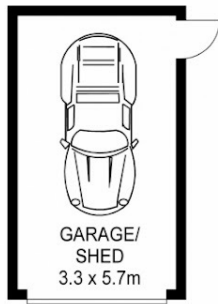

APPROX FLOOR AREA : 196m²



For illustrative purposes only. Not an engineering plan.

Whilst all effort is taken to be correct, this plan may contain inaccuracies or omissions and should be used only as a guide. No representations are made as to the condition, operability or legal status of anything depicted.

Disclaimer: Please note this floor plan is for marketing purposes and is to be used as a guide only. All dimensions are estimates only and may not be exact measurements.