



SOLD

SERENITY BESIDE THE INLET

Set in tranquil surroundings this neat home on a whopping 1214 block is just across the road from the scenic Rutherford Inlet. The home consists of 2 bedrooms, the master bedroom has an ensuite and the other bedroom has built-in robes. A second bathroom is adjacent to the laundry area. The spacious kitchen has a gas stove, rangehood, electric wall oven and extensive cupboards. Adjoining the kitchen is a fabulous meals area. The central massive lounge is filled with natural light and has a Split System Air Conditioner and a Coonara Wood Heater. There is also a long lounge which could be used as an office, games room or third bedroom. The deep yard has plenty of room for all your toys (boats, caravans, trade vehicles, etc). There are six dog kennels - four fenced off dog runs, scented Rose garden (fenced off), inviting fruit trees and two sheds. Other features of the property include exterior canvas blinds and interior blinds. New double thickness fully Block-out and insulated curtains, feature tiles in the kitchen, bathrooms, ensuite and laundry. Security (steel) screen on sliding doors and most windows. The carpet throughout the home is of soft gentle tones. There are solar panels, two instant hot water systems and two driveways. Warneet is a scenic coastal village on the shores of Westernport. There are extensive walking tracks and parks. A Local and School bus stop is nearby. The local general store is just a short walk away as well as the main jetty and North Shore jetty. Warneet Yacht Club, Warneet Boat Ramp, North Shore Boat Club, Warneet Boat Hire are all there for the boating, sailing and kayaking enthusiast. Warneet is an easy drive to Tooradin, Cranbourne, Fountain Gate and the city. Just a lovely place to live.

3 BED | 2 BATH | 1 CAR

PRICE:
\$765,000

OPEN FOR INSPECTION:
N/A



Leon D'Penha
0415205032
leon.dpenha@atrealty.com.au
www.atrealty.com.au

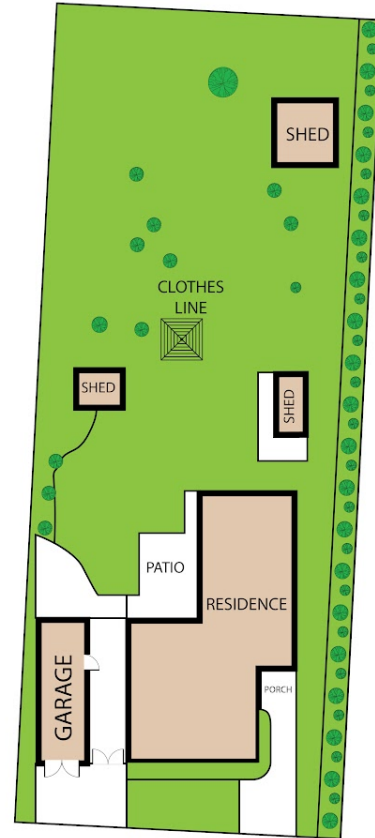

60 Rutherford Parade, Warneet 3980
TOTAL APPROX. FLOOR AREA 148 SQ.M

Whilst every attempt has been made to ensure the accuracy of the floor plan contained here, measurements of doors, windows, rooms and any other items are approximate and no responsibility is taken for any error, omission, or misstatement. This plan is for illustrative purposes only and should be used as such by any prospective purchaser.

Photography and Floorplans by
VISUAL IMPRESSIONS

Disclaimer: Please note this floor plan is for marketing purposes and is to be used as a guide only. All dimensions are estimates only and may not be exact measurements.