



SOLD

STYLISH ONE BEDROOM OVERLOOKING THE FABULOUS GOLD COAST IN VICTORIA TOWERS OVER 50'S

CALL JACKIE FOR YOUR PRIVATE INSPECTION TODAY - 1800 280 893

This stylish apartment has delightful 180 deg views of the ocean, river and hinterland from the balcony and if your goal in life is to get the best out of each day, this is the place for you.

- * Freehold apartment with very reasonable body corp fees
- * Quality fittings and fixtures throughout with imported tiles and 100% wool carpets
- * Impressive galley style kitchen with stone bench tops and stainless steel SMEG appliances
- * Open plan living room that takes advantage of the view and the afternoon sea breezes
- * Magnificent views from the large balcony
- * Ducted air-conditioning throughout for year round comfort
- * Resident's lounge, pool, BBQ, library etc with arranged activities daily
- * 24/7 security and basement parking
- * 4 level AGED CARE facility, HOMECARE available onsite (Physios etc)
- * Security freehold strata title with no exit fees
- * Positioned near Australia Fair Shopping Centre
- * Close to the best restaurants and the Broadwater
- * Light rail at your doorstep

CALL JACKIE TODAY FOR YOUR PRIVATE INSPECTION - 1800 280 893

Disclaimer: We have in preparing this information used our best endeavors to ensure that the information contained herein is true and accurate, but accept no responsibility and disclaim all liability in respect of any errors, omissions, inaccuracies or misstatements that may occur. Prospective purchasers should make their own enquiries to verify the information contained herein.

1 BED | 1 BATH | 1 CAR

PRICE:
\$595,000

OPEN FOR INSPECTION:
N/A



Jackie Taylor-Fox
0411236823
jackietaylorfox@atrealty.com.au
www.atrealty.com.au

FLOORPLAN - TYPE B-S

LEVELS 15 - 25

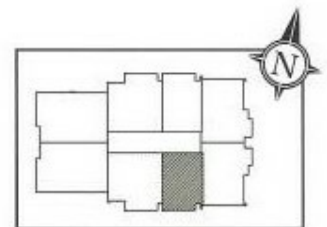

1 BEDROOM + STUDY

Disclaimer: Please note this floor plan is for marketing purposes and is to be used as a guide only. All dimensions are estimates only and may not be exact measurements.

Balcony	12m ²
Total	77m ²