



SOLD

STUNNING 2-BEDROOM COTTAGE IN THE HEART OF TOUKLEY

Discover this pristine 2-bedroom cottage nestled in the heart of Toukley, offering unparalleled convenience with everything you need right at your doorstep. Ideal for those seeking the quintessential Central Coast lifestyle, this immaculate home boasts an array of appealing features.

Key Features:

- Impeccable presentation throughout
- Built-in wardrobes in every bedroom
- Classic clad design with a durable Colorbond roof
- Fully fenced, level block for added privacy
- Single lock-up garage with convenient drive-through access
- Generously high ceilings creating a spacious atmosphere
- A spacious rear deck for outdoor entertaining, plus an additional deck at the front of the home
- Environmentally friendly water tank
- Meticulously maintained gardens adding to the charm
- Stay comfortable year-round with the split-system air conditioning
- Only minutes away from the M1 Motorway for easy commuting

This is your opportunity to embrace the Central Coast lifestyle with this charming cottage as your base. Walking distance to schools, shops, medical facilities, the serene lakefront, beautiful beaches, and an array of cafes and shops, this home offers the perfect blend of comfort, convenience, and coastal living.

Don't miss your chance to make this impeccable property your own. Contact us today to arrange a viewing and experience the allure of Toukley living for yourself.

2 BED | 1 BATH | 1 CAR

PRICE:
\$640,000

OPEN FOR INSPECTION:
N/A



Brad Barker
0413875833
bradbarker@atrealty.com.au
www.atrealty.com.au

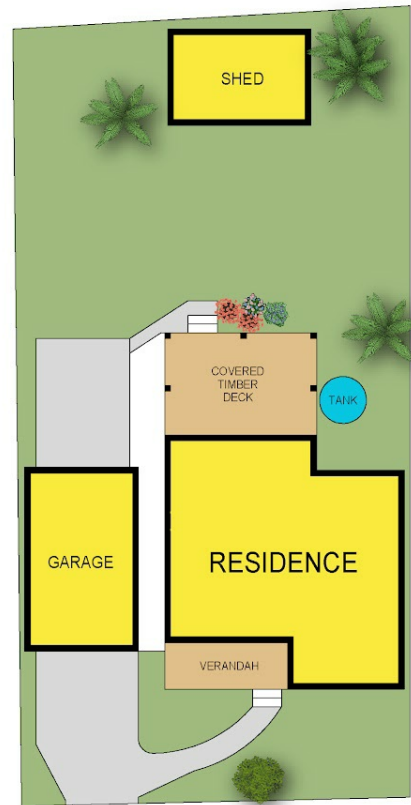
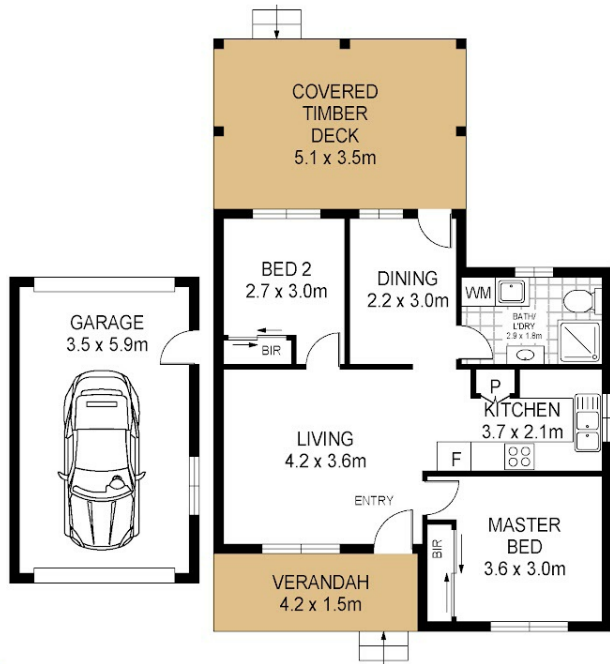
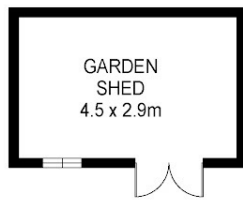

34 Glenavon Street
Toukley



Total Internal Floor Area: 62 sqm (Excluding Garage/ Shed)

Scale in metres Indicative only. Dimensions are approximate. All information contained herein is gathered from sources we believe to be reliable. However we cannot guarantee its accuracy and interested persons should rely on their own enquiries



Disclaimer: Please note this floor plan is for marketing purposes and is to be used as a guide only. All dimensions are estimates only and may not be exact measurements.