

327 ROWLANDS CREEK ROAD, ROWLANDS CREEK, NSW, 2484



**SOLD**

## UNDER CONTRACT

This acreage is truly the one to tick ALL the box's. 72.5 acres with a perfect mix of regenerated forests with walking trails and around 10 acres of flat creek frontage suitable for horses, cattle or small cropping. The elevated house pad sits overlooking its beautiful gardens complete with spring fed dams and an array of native animals that it attracts. The views of Mount Warning from the house and the wet edge pool are sublime both day and night and form the perfect backdrop to relax and rejuvenate. To top it off we even have a very comfortable self contained studio perfect for guests or additional passive income. The home is totally private and feels like a true sanctuary. Situated just 5 minutes drive to the eclectic arts hub of Uki and just 20 minutes to the bustling Northern Rivers Township of Murwillumbah with its fast growing reputation as an arts and foodie destination.

Book your inspection today.

### DISCLAIMER

All information (including but not limited to the property area, floor size, price, address and general property description) is provided as a convenience to you and has been provided to Northern Rivers Property Group / @realty by third parties.

This Information should not be relied upon alone and you should make your own enquiries and seek legal advice in respect to all information about the property contained in this advertisement.

**4 BED | 3 BATH | 6 CAR**

**PRICE:**  
\$2,050,000

**OPEN FOR INSPECTION:**  
N/A



**Paul Stobbie**  
**0448191351**  
paulstobbie@atrealty.com.au  
[northernriverspropertygroup](http://northernriverspropertygroup.com.au)



**STUDIO  
LOWER LEVEL**



**STUDIO  
UPPER LEVEL**

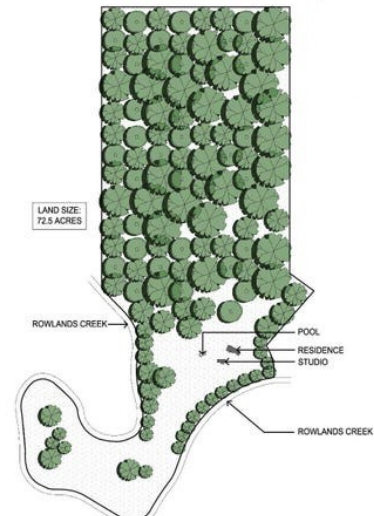

**SITE PLAN**



**RESIDENCE**

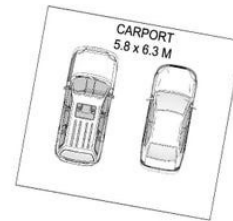

0 1 2 3 4 5

Scale in metres. Indicative only. Dimensions are approximate. All information contained herein is gathered from sources we believe to be reliable. However we cannot guarantee its accuracy and interested persons should rely on their own enquiries.

INTERNAL : 273 SQ.M.  
EXTERNAL : 149 SQ.M.



**327 Rowlands Creek Road, Rowlands Creek**

Disclaimer: Please note this floor plan is for marketing purposes and is to be used as a guide only. All dimensions are estimates only and may not be exact measurements.