



**SOLD**

**COUNTRY STYLE LIVING – SO CLOSE TO THE CITY – NEVER ENDING VIEWS**

Located in Paracombe amongst the North Eastern Adelaide Hills and only 5 Minutes from the hustle and bustle of city life, is this lovely family home - a home that offers a peaceful surround with serene outlooks in a private setting. Located on 2960 square metres (3/4 Acre) of usable land and with wonderful daytime and nighttime views of the City of Adelaide and beyond to the coast. A great place to live as a family, as well as gathering with extended family and friends amongst a beautiful country backdrop, creating memories that will last a lifetime.

The ever popular Red Brick Colonial home was built in 1964 and remains a popular style of home to this day, sought after by buyers. The land allows for the new buyers, to put up more out buildings for extra storage if they require it.

The home itself consists of 4 bedrooms, lounge/dining, kitchen/casual meals, family room, 2 bathrooms, 2 toilets and separate laundry. There is reverse cycle ducted air conditioning, timber floors, formal entry hall and passage way.

Features inside the home include the master bedroom, the bedroom is very large and could include a parents retreat if desired. The ensuite is also a large room and includes a double shower, a double spa and a wc.

The family room allows you to look out to views across the whole back yard and to Adelaide. It leads to the fabulous outdoor entertainment area with elevated timber deck and hand rails. A great spot for barbecues and get togethers. Other features inside include the bay window in the lounge, including a window seat. The main bathroom has a separate shower and a deep bath and some built-in shelving and a linen cupboard.

Outside features include a single carport and an extra large 9.8 metre by 6 metre garage/workshop. There is plenty of flat land for extra parking, there is access to the rear of the property and plenty of land to create more outbuildings.

If you are looking for peace and quiet and your own little bit of country life style this is it. There is so much to like about this wonderful property and all this is just 5 minutes from suburbia and 30 minutes to the CBD, 45 minutes to Barossa Valley and about an hour to the river. There are nature walks at you back gate and some beautiful Australian flora and fauna.

- Highly Recommended please see below for dot point features.
- Country Style Living – So Close to the City – Never Ending Views
  - Wonderful Location just minutes from the hustle and bustle of city life
  - Red Brick – Tiled Roof Colonial Style Home on ¾ Acre of Land

**4 BED | 2 BATH | 1 CAR**

**PRICE:**  
\$880,000

**OPEN FOR INSPECTION:**  
N/A



**Jon Downs**  
0412977914  
jondowns@atrealty.com.au  
[www.atrealty.com.au](http://www.atrealty.com.au)  
RLA: 269823

104 Churchett road,  
**PARACOMBE**

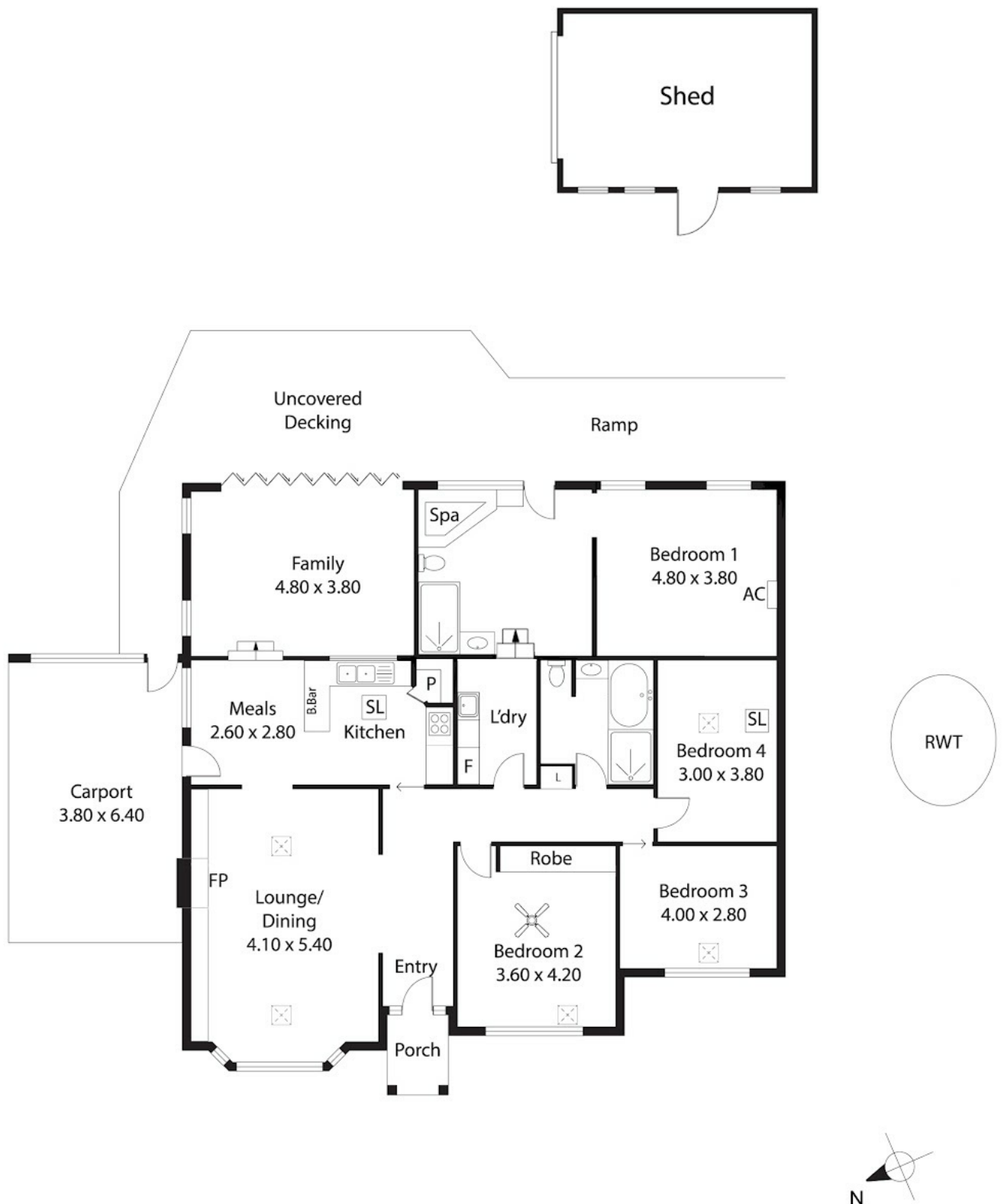

Disclaimer: Please note this floor plan is for marketing purposes and is to be used as a guide only. All dimensions are estimates only and may not be exact measurements.

Shed: 58.80SQ.M  
 Decking: 31.84SQ.M

**Jon Downs**  
 0412977914  
 jondowns@atrealty.com.au  
[www.atrealty.com.au](http://www.atrealty.com.au)

This Drawing is for illustration purposes only. All measurements are internal and approximate. Details intended to be relied upon should be independently verified.

