

# SOLD

## UNIQUE WOW FACTOR TOWNHOUSE

Boasting a private rear deck entertainment area, shed this home is filled with breeze. Located in a very quiet street, close to shops, schools & public transport.

At ground level is an open plan living and dining area with a modern aesthetic, touches of trendy exposed brick and feature lighting as well as timber look flooring underfoot. The kitchen has been renovated with beautiful stone counters and cabinetry along with a servery through to the dining room adjacent and backlit display shelving as well.

Upstairs the home has two big bedrooms, the master is super sized with a walk in robe and has sliding door access through to the balcony. At the top of the staircase you will find a linen cupboard for more storage. The bathroom has a large shower recess and vanity with storage plus separate toilet. At ground level is the laundry with a second toilet.

- Two bedroom townhouse home in a great Northern Suburbs location
- Super sized master bedroom suite with walk in robe and sliding door to balcony
- Bedroom 2 includes a large built in robe as well
- Main bathroom upstairs offers a large shower and separate toilet
- Ground level open plan living and dining areas
- Internal laundry room with storage space and second W/C
- Kitchen offers loads of built in storage and wrap around counters
- Built in storage space under staircase
- Large private rear deck, with shade sails and shed storage
- Easy access single carport parking bay at the front with a porch
- Established garden at front of townhouse

Around the Suburb:

- Moments from the Hibiscus and Casuarina Shopping Centres
- Nearby to the Casuarina Coastal Reserve and ocean views
- CDU and RDH are both nearby
- Leanyer Primary School, Good Shepherd Primary School and daycare options within suburb

Council Rates: Approx. \$1,700 per annum

Area Under Title: 320sqm

Zoning: LMR (Low-Medium Density Residential)

2 BED | 1 BATH | 1 CAR

PRICE:  
\$395,000

OPEN FOR INSPECTION:  
N/A



**Nicole Wheeler**  
0417508800  
nicolewheeler@atrealty.com.au  
[www.atrealty.com.au](http://www.atrealty.com.au)

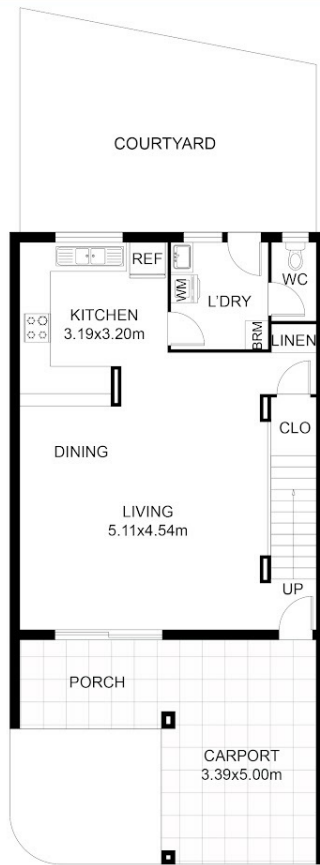

**GROUND FLOOR PLAN**



**FIRST FLOOR PLAN**

This floor plan including furniture, fixture measurements and dimensions are approximate and for illustrative purposes only. @Realty gives no guarantee, warranty or representation as to the accuracy and layout. All enquiries must be directed to the agent, vendor or party representing this floor plan.

### 3/5 Grassland Cres Leanyer

Disclaimer: Please note this floor plan is for marketing purposes and is to be used as a guide only. All dimensions are estimates only and may not be exact measurements.