



SOLD

OUTSTANDING FAMILY POTENTIAL, JUST A SHORT STROLL TO TOWN.

Resting on a low-maintenance 705sqm approx. block, just a short stroll to schools, parkland, shopping and trains, this contemporary four-bedroom home is ready to move in and enjoy the peaceful surroundings.

Inside you are greeted by the spacious and light-filled living and dining domain, with split system air conditioner on hand to keep you cool over the summer months. Stepping down to the central meals domain and kitchen, the resident chef will relish stylish subway tiled splashbacks, wraparound benches and quality stainless steel appliances. Sliding doors lead out to the sun-splashed paved patio and lush lawns of the backyard, offering ample space for entertaining as you watch the kids and pets play. Positioned for privacy, the main bedroom flaunts a walk-in robe and luxe ensuite, while three further bedrooms are serviced by the sparkling family bathroom.

Adding to the appeal, a remote garage with convenient rear roller door access, ducted heating, plus a fabulously convenient location, within walking distance of both Drouin Primary and Secondary College, and a pleasant stroll to shops, eateries, services and trains in town.

- Contemporary 4-bed, 2-bath family home
- Light-filled open plan living & dining on entry
- Sparkling modern kitchen with quality SS appliances
- Luxe main bedroom flaunts walk-in robe & ensuite
- Three further bedrooms, two with built-in robe storage
- Family bathroom boasts shower, vanity, bath & separate toilet
- Generous laundry with linen press & access to rear
- Sliding doors reveal paved patio & lush lawns of backyard
- Remote double garage with convenient rear roller door access
- Ducting heating throughout & split system AC in living zone
- Low-maintenance 705sqm approx. block, with fully fenced rear yard
- Pleasant walk to schools, shops, dining & trains in town

4 BED | 2 BATH | 2 CAR

PRICE:
\$635,535

OPEN FOR INSPECTION:
N/A



Lou Rinnovasi
0417166668
lou@atrealty.com.au
www.atrealty.com.au

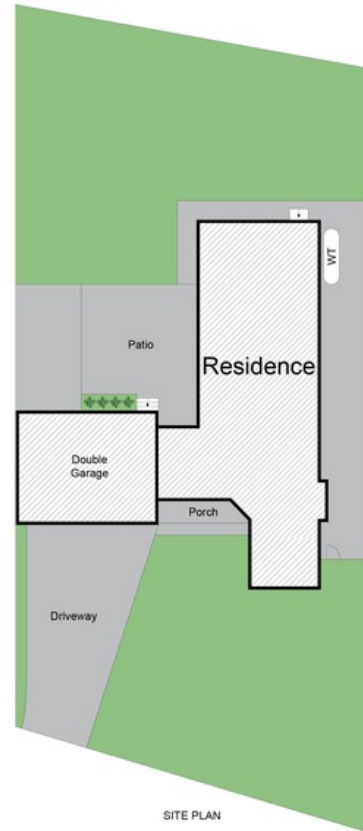

The floor plan is not to scale; measurements are indicative and in metres. Exterior elements are not in position. Plans should not be relied on. Interested parties should make and rely on their own enquiries. The information on this brochure has been supplied to us by the property owner, while we have no cause to doubt its accuracy, we provide no guarantee. We cannot attest to the functionality of any fixtures, fitting or inclusions to the property. Land and apartment dimensions and floorsite plans are supplied by third parties. Typing mistakes, omissions, transposing can occur, we provide to assist but make no representation. Buyers must carry out their own due diligence. Photo ID and contact details are required at all open inspections.

Disclaimer: Please note this floor plan is for marketing purposes and is to be used as a guide only. All dimensions are estimates only and may not be exact measurements.