



SOLD

IMMACULATE FAMILY LIVING IN WYNDHAM GREEN!

Situated in the highly sought-after Wyndham Green and overlooking picturesque views, you will find this gorgeous double-storey family home full of character and charm.

Bright and spacious, this beautiful property feels homely, is flawlessly presented, and offers a practical family floor plan. Upon entry, you're greeted by a generous formal lounge. Through the hallway, you are directed to the functional open-plan kitchen with quality appliances and an abundance of bench and cupboard space, all overlooking the meals and family area. Leading out to the beautifully landscaped gardens and an undercover entertaining zone, this area is perfect for gatherings heading into summer.

Upstairs, there are three spacious bedrooms. The master bedroom offers a walk-in wardrobe and a full ensuite. The remaining two bedrooms have built-in robes and are positioned around the central bathroom. Other great features include gas ducted heating, an undercover carport, and a balcony - perfect for a morning cuppa.

Located within a short distance of the newly expanded Manor Lakes Central Shopping Centre, Wyndham Vale Train Station, public transport, childcare, walking trails, and parks, this home is sure to impress. Inspections are a must! For enviable, easy-care living in an exceptional lifestyle location, look no further than this lovely home.

4 BED | 2 BATH | 2 CAR

PRICE:
\$570,000

OPEN FOR INSPECTION:
N/A



Joseph Hanna
0423966320
joseph@atrealty.com.au
www.atrealty.com.au

Ground Floor



First Floor

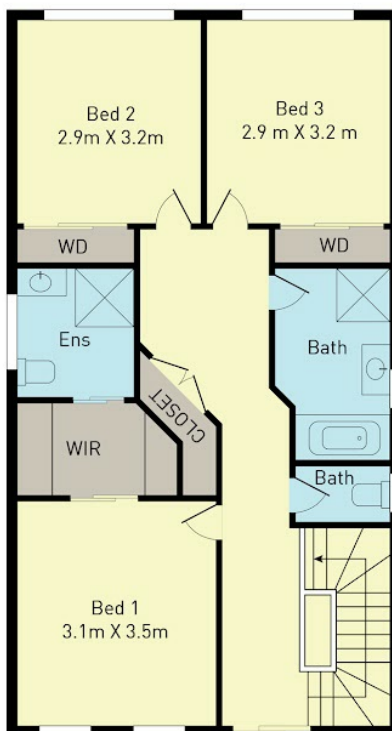

Site Plan

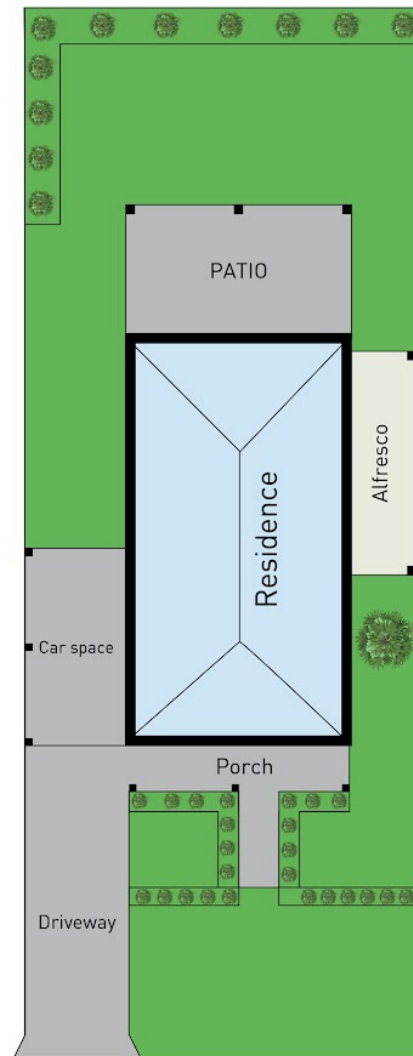

Internal 127 m²

18 Mayfair Street, Wyndham Vale

* Dimensions are approximate and for illustrative purpose only

Disclaimer: Please note this floor plan is for marketing purposes and is to be used as a guide only. All dimensions are estimates only and may not be exact measurements.