

FOR SALE

THE STORIES SHE COULD TELL...

Take a step back in time without losing all the comforts of modern living. The Old Corner Post Office exudes all the charm of yesteryear and it's just so true that 'they don't make them like they used to'.

The building was constructed in 1904 and contains original features such as stained glass windows, timber floor boards, mantles and fire places, stunning ceiling roses, architraves and grand, high ceilings. Combined with a complete renovation including fresh paint, carpets, zoned gas ducted heating, new bathrooms and kitchen, this home is ready to move straight into with all the hard work having been completed.

The home is zoned Mixed Use and currently operating as a gift shop and residence, but is essentially the most beautiful four bedroom home located only a short walk to Primary Schools, delightful cafes, Burra Brewery, book & gift shops and not forgetting, art gallery, Community Hub and the Great Southern Rail Trail, to name just a few attractions in picturesque Korumburra.

There is an abundance of living space with a large living and dining area with timber-lined ceilings and over 100 years of handwritten stories to tell. There is a separate living area/family room plus the open plan kitchen area with the option of a dining space or sitting area.

Both bathrooms are sure to impress with quality replica fittings, pressed tin features and the luxurious claw bath in the main bathroom.

A couple of hidden gems will greet you upon inspection and include the private yard with country-themed, landscaped gardens, shed for storage (under-house storage also available), private sitting areas, play space for children or pets, covered outdoor entertaining area with awnings for use throughout any season.

This incredible home is worthy of an inspection and could lend itself to many opportunities if so desired. (STCA)

4 BED | 3 BATH | 2 CAR

PRICE:

\$1,300,000 - \$1,400,000

OPEN FOR INSPECTION:

N/A



Christie Nelson

0407812904

christienelson@atrealty.com.au

[Christie Nelson Real Estate](#)

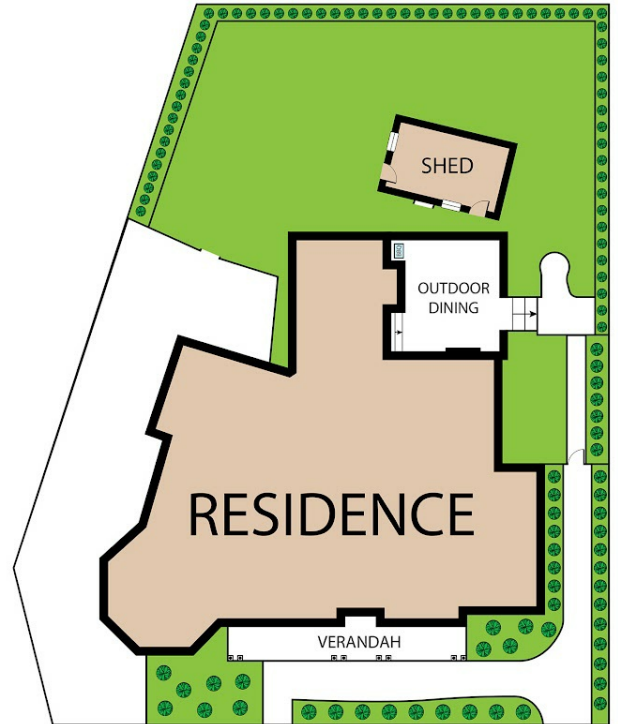

Disclaimer: Please note this floor plan is for marketing purposes and is to be used as a guide only. All dimensions are estimates only and may not be exact measurements.