



**SOLD**

## YOUR DREAM BEACHSIDE HOMESITE!

Welcome to Burrum Heads, a stunning coastal town with the original fishing town feel, plus modern facilities like new all weather boat ramp and local shopping. It's all you need for a quiet beach side lifestyle, and it's within half an hour of major shopping and services in Maryborough or Hervey Bay.

Where else in Queensland can you by vacant block by the beach?

Basic Facts:

- Currently titled land, ready for immediate settlement!
- All services available - town water, sewerage, underground power, NBN.
- 891m2, level, part fenced, with your own direct access to the beachside reserve.
- Excellent North / East aspect.

This prime parcel of land is a fantastic opportunity, perfect for any savvy real estate investor or those looking to build their dream home. On offer is 891 square meters of level land, ready for you to turn into something truly amazing. The construction covenant is in place to keep the visual amenity of this area as lovely as it is today, expect to see more attractive, quality homes around you as this stage develops. This block has it's own gate in the back fence and staircase running down to the park reserve and beach.

With a tropical climate and perfect conditions for fishing, Burrum Heads is a great place to call home. It's a fantastic opportunity for a holiday home too - use your house as a holiday rental until you are ready to retire.

Within walking distance of this land are pristine beaches and a number of lovely parks, where you can walk, swim or just relax and take in the peaceful atmosphere. You can also explore the surrounding areas, such as the nearby national park.

Don't let this opportunity slip away – come and explore this beautiful piece of land and see what it has to offer!

Contact Paul Thompson @realty 0419 772 354.

0 BED | 0 BATH | 0 CAR

PRICE:  
\$490,000

OPEN FOR INSPECTION:  
N/A



**Paul Thompson**  
**0419772354**  
paulthompson@atrealty.com.au  
[www.paulthompsonproperty.com.au](http://www.paulthompsonproperty.com.au)

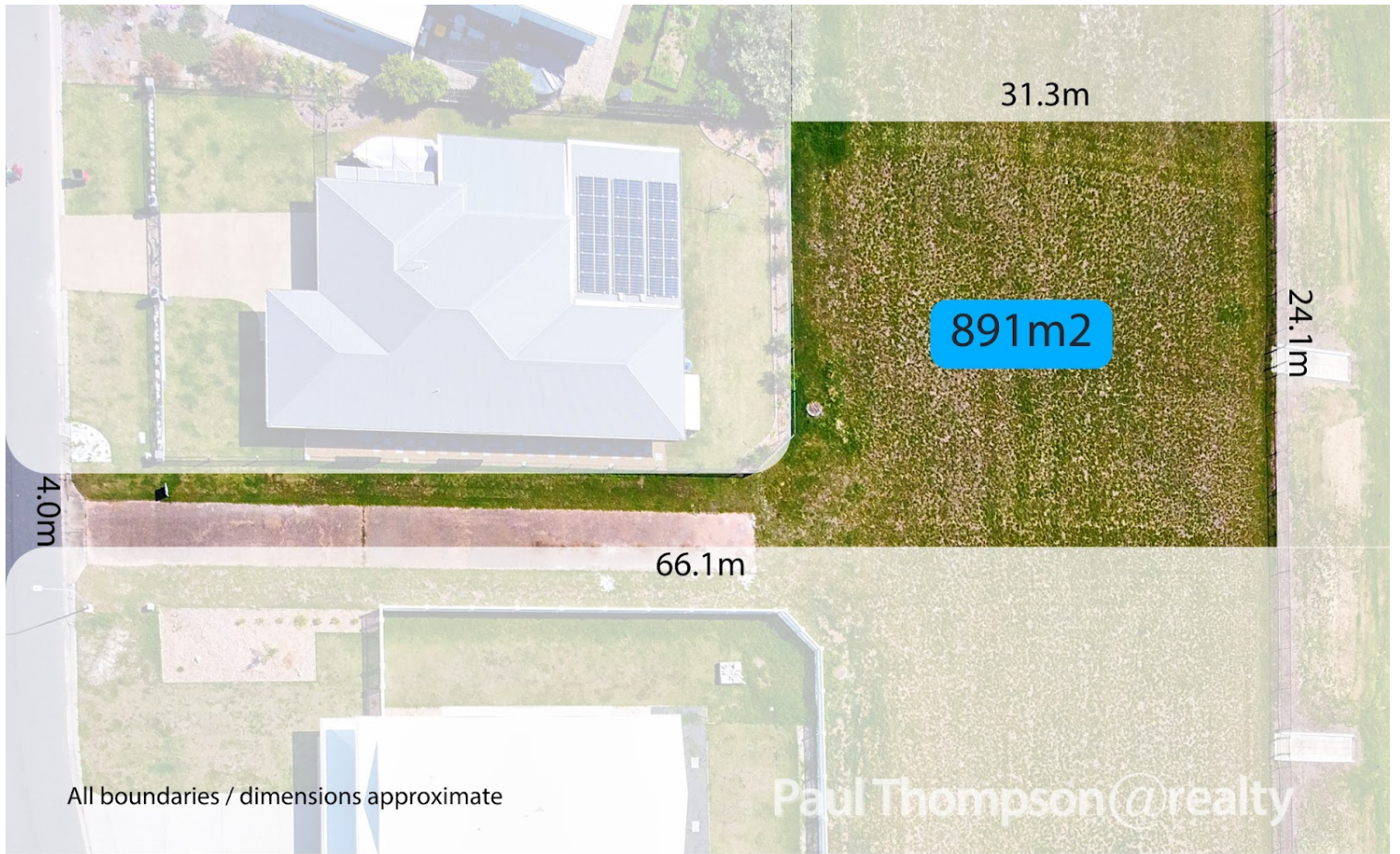

31.3m

891m<sup>2</sup>

24.1m

66.1m

4.0m

All boundaries / dimensions approximate

Paul Thompson @realty

Disclaimer: Please note this floor plan is for marketing purposes and is to be used as a guide only. All dimensions are estimates only and may not be exact measurements.